

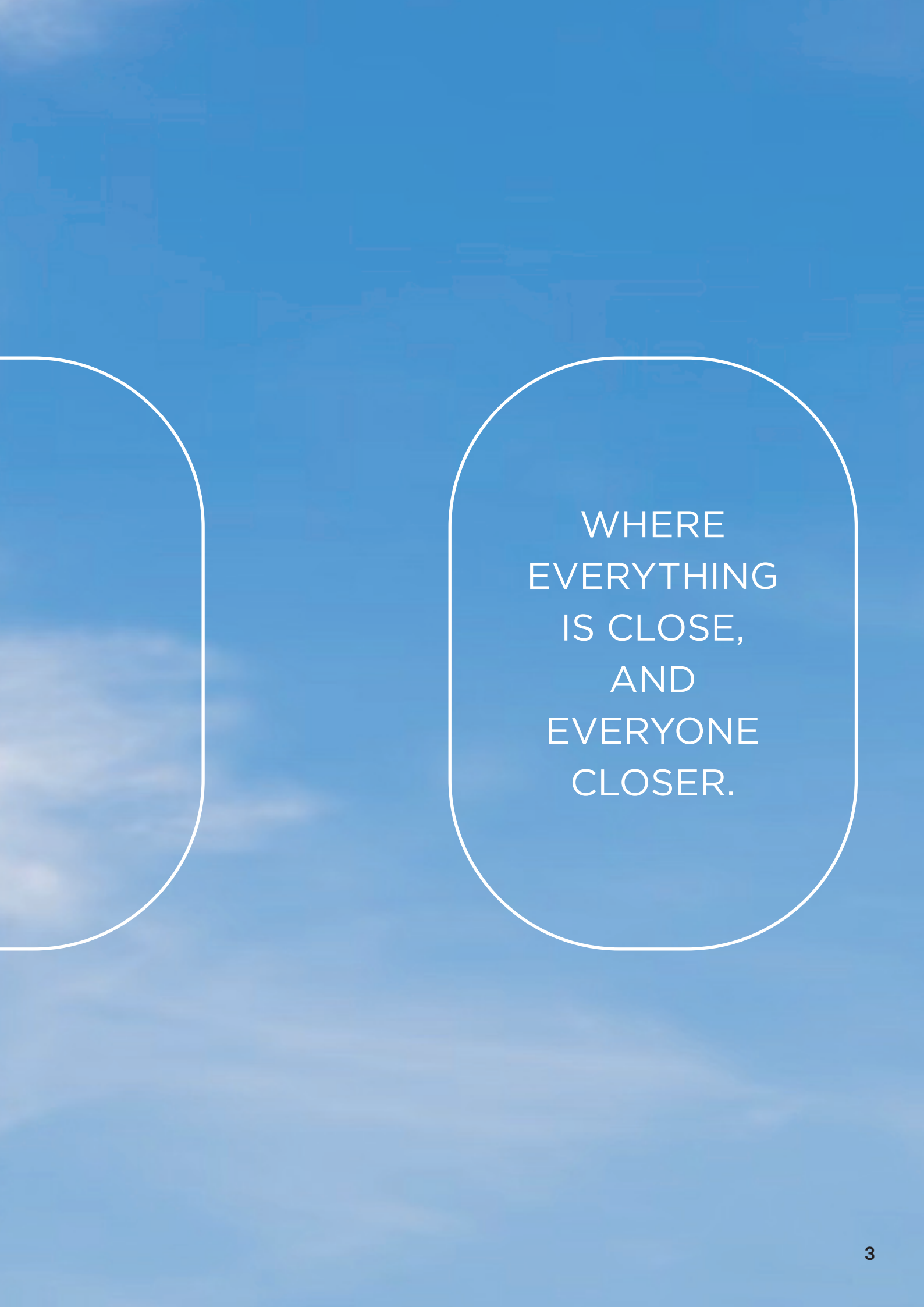

WHERE  
EVERYTHING  
IS CLOSE,  
AND  
EVERYONE  
CLOSER.





WHERE  
EVERYTHING  
IS CLOSE,  
AND  
EVERYONE  
CLOSER.



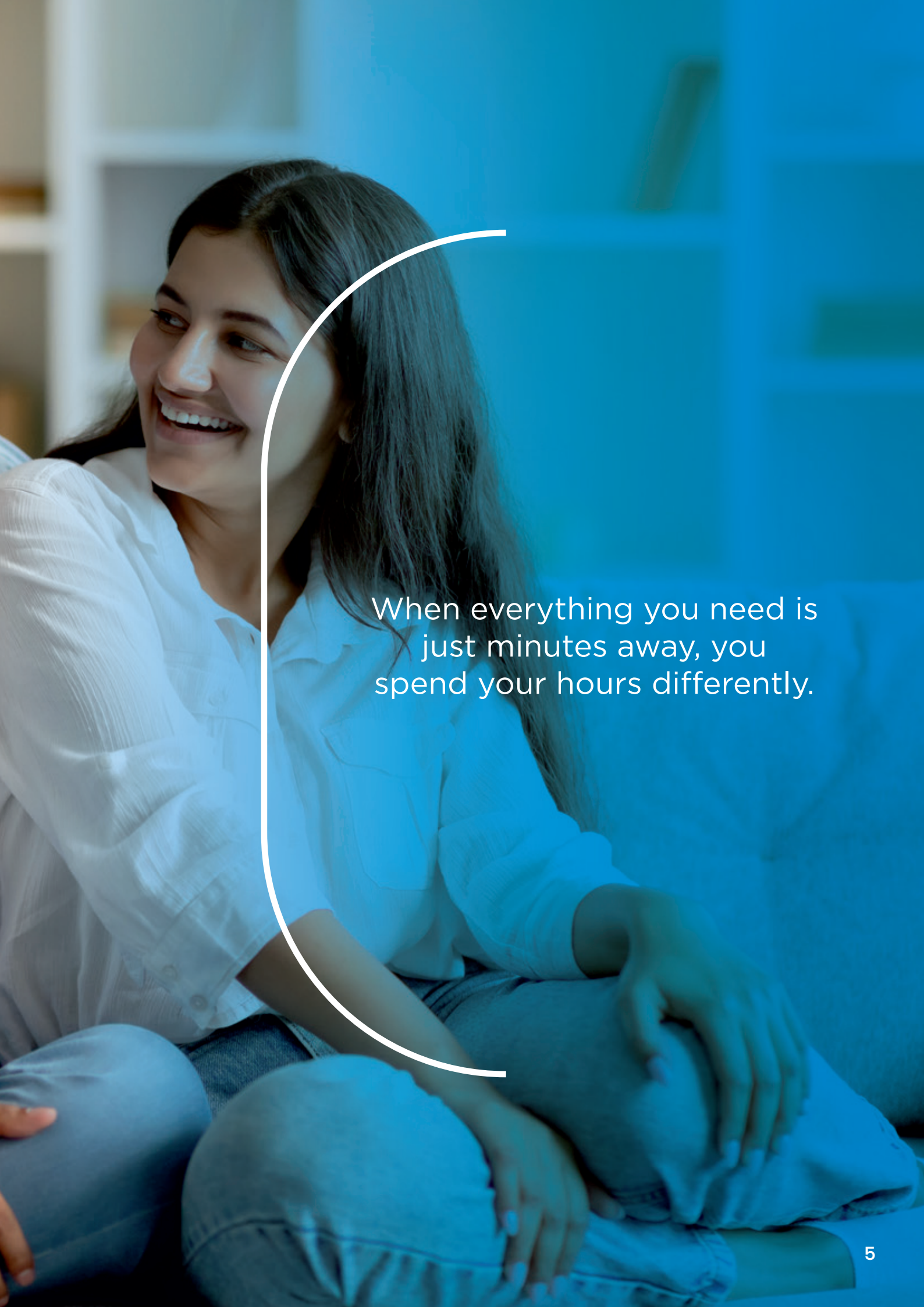

When everything you need is  
just minutes away, you  
spend your hours differently.





Less on the road—more at  
the dining table or  
in the clubhouse with  
the ones who matter  
the most.



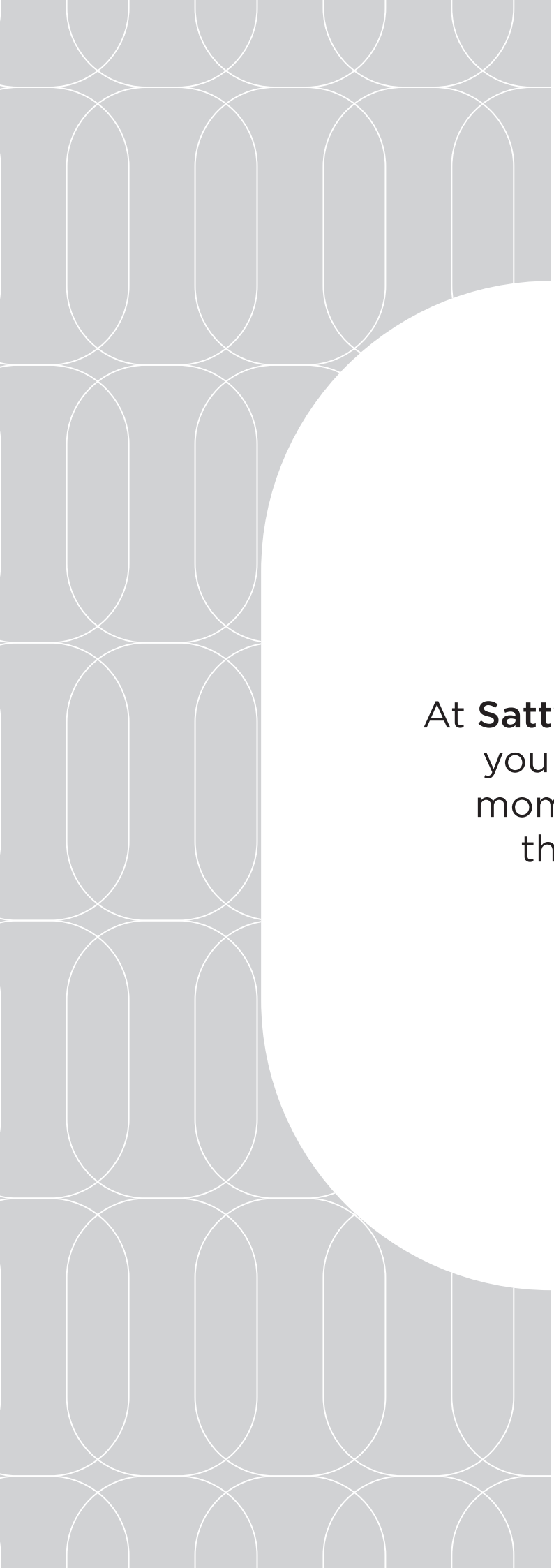

At **Sattva Aeropolis Phase 2**,  
you get back precious  
moments to share with  
the ones you love.





BIRD'S  
EYE VIEW





 **SATTVA**  
**AEROPOLIS**  
PHASE 2

**Studios, 1 and 3 BHKs** to accommodate every lifestyle.

Strategically located in North Bengaluru, near **Kempegowda International Airport**, **Sattva Aeropolis Phase 2** keeps you connected to the city, and to the people and moments that matter the most.







A person wearing a dark denim jacket is shown from the side, holding two shopping bags (one black, one light green). The background is a blurred city street with warm lights and a blue tint. A large white circle is overlaid on the image, containing text.

**Sattva Aeropolis Phase 2** is perfectly placed in **North Bengaluru's growth corridor**, just minutes from the airport.

It keeps you connected to the city's pulse, yet never far from the calm of home. And, when it comes to daily life, you'll find everything close at hand—schools, hospitals, work hubs, and shopping, all within easy reach.

What that really means: more evenings with friends and family, and more moments that belong to you.

# 5 MINUTES FROM THE AIRPORT. CLOSER TO EVERY MOMENT THAT COUNTS.



## LANDMARKS AND LOCALITY

Airport Railway Station—1 km  
 Bengaluru International Airport—3.4 km  
 Devanahalli Town—6.6 km  
 Yelahanka—13.8 km  
 Jakkur Aerodrome—19.9 km  
 Hebbal—25.5 km  
 Nandi Hills—25.7 km



## EDUCATIONAL INSTITUTES

Dr. A. P. J. Abdul Kalam English School—2.4 km  
 NAFL (NPS)—2.7 km  
 Oxford English School—8 km  
 EuroKids School—8.3 km  
 Akash International School—9 km  
 Air Force School, Yelahanka—12.4 km  
 Ryan International School—14.7 km  
 Armed Police Training School—14.7 km



## HOSPITALS

Akash Hospital—6.7 km  
 Ramaiah Leena Hospital—7.5 km  
 Sri Shirdi Sai Hospital—7.6 km  
 New Manasa Hospital—8 km  
 Aster CMI Hospital—22.7 km  
 Manipal Hospital—23 km



## SHOPPING MALLS

RMZ Galleria Mall—16.5 km  
 Esteem Mall—23.3 km



## IT PARKS

Prestige Tech Cloud—4.3 km  
 Signature Business Park—4.5 km  
 Devanahalli Business Park—4.9 km  
 KIADB Aerospace Park—12 km  
 Ecopolis Tech Park—12 km  
 Manyata Tech Park—21.9 km  
 Kirloskar Tech Park—23.1 km

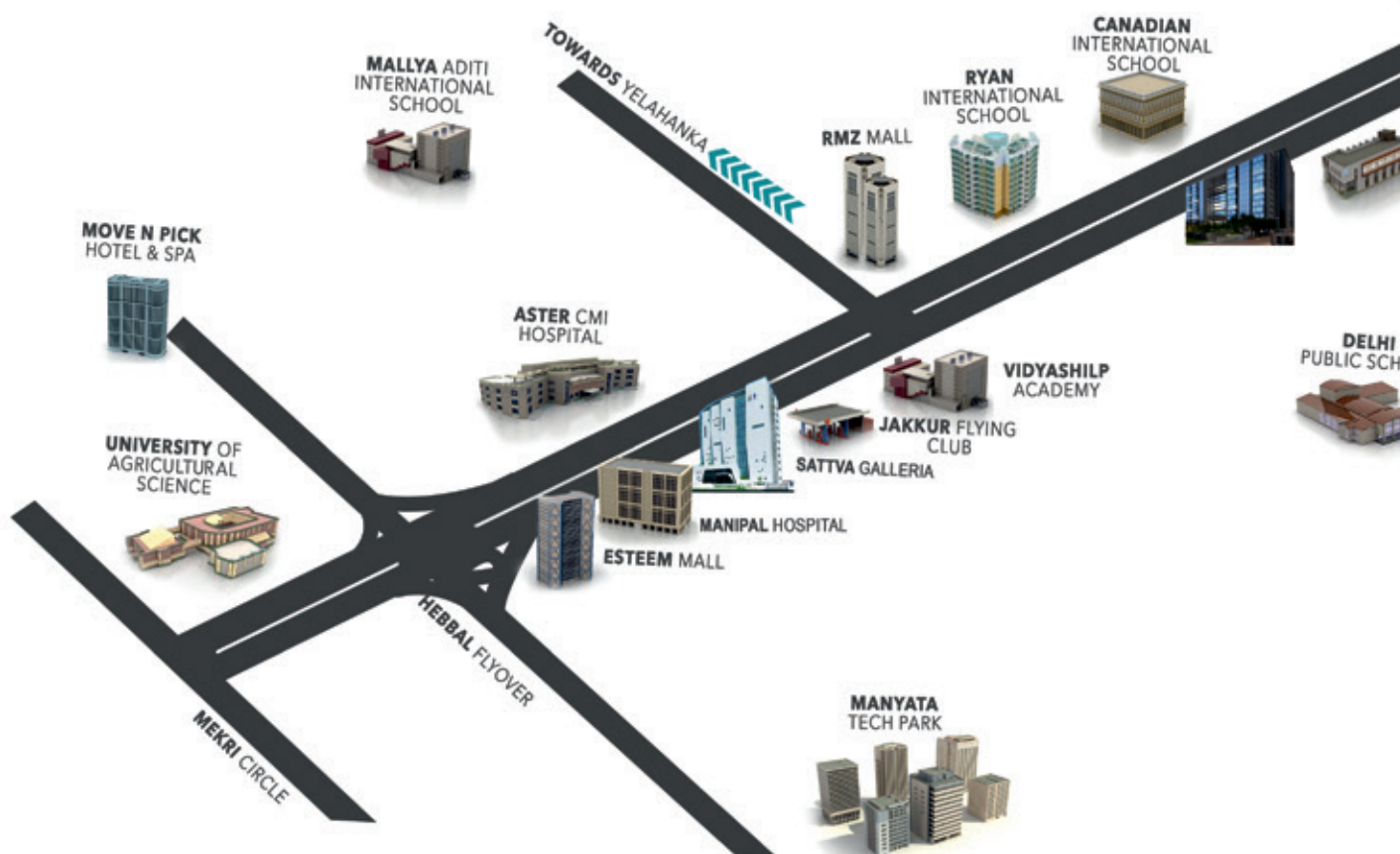

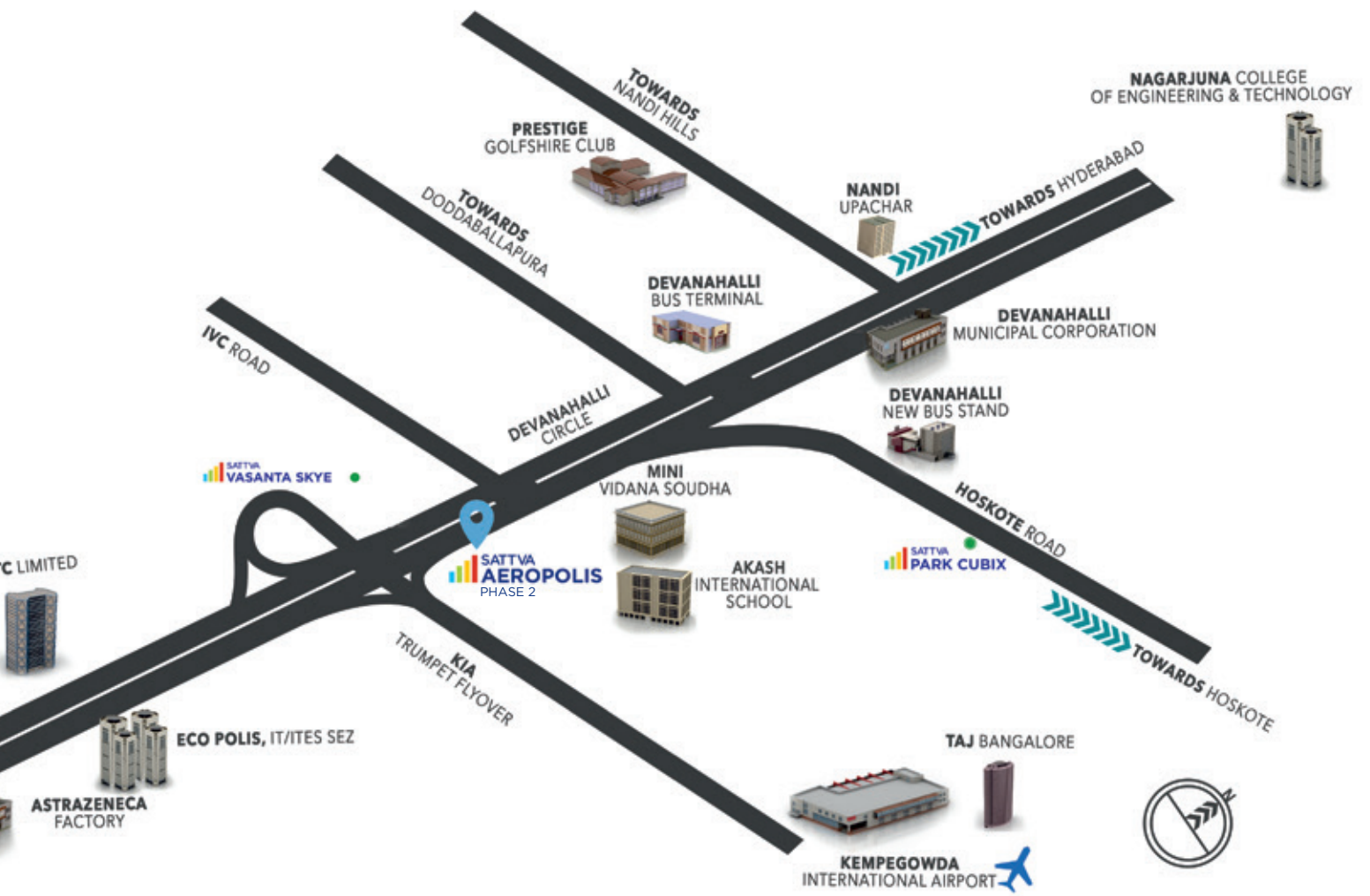



LIFE FEELS  
LIGHTER HERE.



## **Sattva Aeropolis Phase 2**

is designed for community living. Morning walks, playtime, evenings at the clubhouse, or quiet moments in the gardens—life here feels connected, healthy, and fulfilling.

- **80% open spaces**
- **Landscaped walkways**
- **Vehicle-free zones**
- **Clubhouse and community spaces**

MASTER PLAN



## LEGEND

1. Entry / Exit
2. Visitor waiting area
3. Lawn
4. Party lawn
5. Temple
6. Seating deck
7. Circular plaza with pergola
8. Futsal court
9. Cricket practice pitch
10. Seating under pergola
11. Kid's play area
12. Parking
13. Elder's park
14. Lotus pond
15. Chit chat corner
16. Plumeria court
17. Visitor parking
18. Gazebo
19. Open gym
20. Yoha lawn
21. Mound
22. Multipurpose lawn
23. Sitting plaza
24. Swimming pool
25. Pool deck
26. Kid's pool
27. Foot reflexology
28. Jogging track
29. Toddler's play area
30. Hopscotch
31. Drop off





## ACTIVE OUTDOOR

Step outside to spaces that bring daily life closer to nature and community.

From play areas for children to fitness in the open air and peaceful corners for elders, the outdoors here is part of your everyday rhythm.



OUTDOOR



## OPEN GYM

Fitness under the open sky—workouts feel lighter in the fresh air.



### ELDER'S PARK

A quiet corner crafted for conversations, evening strolls, or simply unwinding amidst green surroundings.



### KID'S PLAY AREA

A safe, joyful space where little ones can run, climb, and make memories every day.





## EXCLUSIVE CLUBHOUSE

Step into the clubhouse and you'll find spaces that bring people closer—whether it's a celebration with neighbours, a game with friends, or an afternoon swim with the kids.



INDOOR



## SWIMMING POOL WITH KID'S POOL

Whether it's laps to start your morning or splashes on a sunny afternoon, the pool has room for everyone.



## GYM

Fully equipped to keep your fitness goals within easy reach, every day.



## YOGA ROOM

A calming space to stretch, breathe, and find balance.



## MULTI-PURPOSE HALL

A space for celebrations, gatherings, and moments that bring everyone together.



## LIBRARY

A quiet retreat for readers,  
learners, and thinkers.



## INDOOR GAMES

A calming space to stretch, breathe,  
and find balance.



SPECIFICATION

### Disclaimer

Please read the project specifications in conjunction with the apartment drawings, as some of the items mentioned in the specifications may not be applicable to every apartment.

Model apartments for the project are only for reference in terms of layout. However, some changes are made to enhance the appeal of the space that are not part of the standard apartment. For example, furniture, false ceiling works, wall paneling, additional electrical points, cladding, etc. You are advised to refer to the attached specifications for clarity on standard deliverables.

Finishes such as tiles/ natural or artificial stones, fittings and fixtures shown in model apartment may require to be changed during project construction due to various factors, such as, non-availability or discontinuation or inconsistent quality issues. Under such circumstances, we will ensure replacement with appropriate material of similar or different size, texture, design or colour.

To enable customization as per interior design, sink, counter and wall cladding in kitchen are not part of standard offering in the apartment.

### Structure

R.C.C frame structure

### Common area finishes

- Ground floor entrance lobby: Granite/ Marble/ Engineered stone/Tile.
- Lift lobby and corridors: Tile flooring.
- Staircase treads and risers: Stone/Tile.

### Apartment finishes

- Foyer/Living and dining : Tile flooring
- Master bedroom : Tile flooring
- Other bedrooms : Tile flooring
- Balcony/Utility : Tile flooring
- Kitchen : Tile flooring
- Toilet : Tile flooring and cladding up to false ceiling height.

### Apartment doors and windows:

- Main door and internal doors: RCC / Timber door frame with timber shutter.
- Sliding doors and windows: UPVC/ Aluminium frame with glazing.

### Paint finishes

- Exterior walls including balcony and utility, finished with weather coat paint or as per design.
- Internal walls and ceiling in apartments finished with oil bound distemper paint.
- MS railings/ grills finished with enamel paint.

### Lifts

- Automatic Passenger/service lift.

### Security systems

- CCTV cameras are provided at strategic locations.

### Electrical/Plumbing

- HT power connection for all apartments & common areas.
- Intercom and telephone point in living.
- TV point for living and master bedroom.
- 16 Amp points for master bedroom for AC.

### Kitchen/Utility

- 150 mm dia sleeve for kitchen chimney exhaust.

### Toilet - CP and sanitary fittings

- Premium quality plumbing fixtures.
- Floor mounted with exposed tank.

### Facilities offered at extra cost

- 100% power back up.
- Reticulated gas piping connection for kitchen.

# BLOCK A WING 1 - TYPICAL PLAN

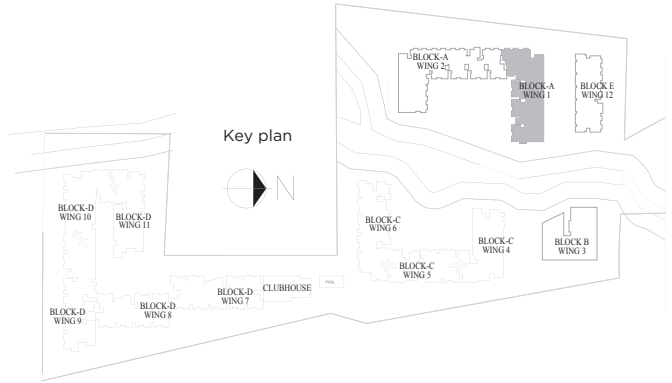

A2-102 TO A2-1102  
STUDIO (Type 3)  
SBA : 447 Sq.Ft.  
Carpet : 278 Sq.Ft.  
Balcony : 21 Sq.Ft.

A2-103 TO A2-1103  
STUDIO (Type 3)  
SBA : 443 Sq.Ft.  
Carpet : 278 Sq.Ft.  
Balcony : 21 Sq.Ft.

A2-104 TO A2-1104  
STUDIO (Type 3)  
SBA : 448 Sq.Ft.  
Carpet : 278 Sq.Ft.  
Balcony : 21 Sq.Ft.



A1-101 TO A1-1101  
STUDIO (Type 3)  
SBA : 453 Sq.Ft.  
Carpet : 278 Sq.Ft.  
Balcony : 21 Sq.Ft.

A1-105 TO A1-1105  
1BHK+1T (Type 2B)  
SBA : 654 Sq.Ft.  
Carpet : 388 Sq.Ft.  
Balcony : 31 Sq.Ft.

A1-106 TO A1-1106  
1BHK+1T (Type 2B)  
SBA : 650 Sq.Ft.  
Carpet : 388 Sq.Ft.  
Balcony : 31 Sq.Ft.

A1-114 TO A1-1114  
3BHK+2T (Type 1B)  
SBA : 1004 Sq.Ft.  
Carpet : 644 Sq.Ft.  
Balcony : 30 Sq.Ft.

A1-107 TO A1-1107  
1BHK+1T (Type 2B)  
SBA : 650 Sq.Ft.  
Carpet : 388 Sq.Ft.  
Balcony : 31 Sq.Ft.

A1-108 TO A1-1108  
1BHK+1T (Type 2B)  
SBA : 650 Sq.Ft.  
Carpet : 388 Sq.Ft.  
Balcony : 31 Sq.Ft.

A1-113 TO A1-1113  
3BHK+2T (Type 1B)  
SBA : 1004 Sq.Ft.  
Carpet : 644 Sq.Ft.  
Balcony : 30 Sq.Ft.

A1-109 TO A1-1109  
1BHK+1T (Type 2B)  
SBA : 650 Sq.Ft.  
Carpet : 388 Sq.Ft.  
Balcony : 31 Sq.Ft.

A1-110 TO A1-1110  
1BHK+1T (Type 2B)  
SBA : 650 Sq.Ft.  
Carpet : 388 Sq.Ft.  
Balcony : 31 Sq.Ft.

A1-112 TO A1-1112  
3BHK+2T (Type 1B)  
SBA : 1004 Sq.Ft.  
Carpet : 644 Sq.Ft.  
Balcony : 30 Sq.Ft.

A1-111 TO A1-1111  
1BHK+1T (Type 2B)  
SBA : 658 Sq.Ft.  
Carpet : 388 Sq.Ft.  
Balcony : 31 Sq.Ft.

# BLOCK A WING 2 - TYPICAL PLAN

A2-102 TO A2-1102  
STUDIO (Type 3)  
SBA : 447 Sq.Ft.  
Carpet : 278 Sq.Ft.  
Balcony : 21 Sq.Ft.

A2-101 TO A2-1101  
STUDIO (Type 3)  
SBA : 447 Sq.Ft.  
Carpet : 278 Sq.Ft.  
Balcony : 21 Sq.Ft.

A2-120 TO A2-1120  
STUDIO (Type 3)  
SBA : 449 Sq.Ft.  
Carpet : 278 Sq.Ft.  
Balcony : 21 Sq.Ft.

A2-119 TO A2-1119  
STUDIO (Type 3)  
SBA : 443 Sq.Ft.  
Carpet : 278 Sq.Ft.  
Balcony : 21 Sq.Ft.

A2-118 TO A2-1118  
STUDIO (Type 3)  
SBA : 443 Sq.Ft.  
Carpet : 278 Sq.Ft.  
Balcony : 21 Sq.Ft.

A2-117 TO A2-1117  
STUDIO (Type 3)  
SBA : 443 Sq.Ft.  
Carpet : 278 Sq.Ft.  
Balcony : 21 Sq.Ft.

A2-116 TO A2-1116  
STUDIO (Type 3)  
SBA : 443 Sq.Ft.  
Carpet : 278 Sq.Ft.  
Balcony : 21 Sq.Ft.

A2-115 TO A2-1115  
STUDIO (Type 3)  
SBA : 446 Sq.Ft.  
Carpet : 278 Sq.Ft.  
Balcony : 21 Sq.Ft.

A2-103 TO A2-1103  
3BHK+2T (Type 3A)  
SBA : 1004 Sq.Ft.  
Carpet : 644 Sq.Ft.  
Balcony : 30 Sq.Ft.

A2-104 TO A2-1104  
3BHK+2T (Type 3A)  
SBA : 1004 Sq.Ft.  
Carpet : 644 Sq.Ft.  
Balcony : 30 Sq.Ft.

A2-105 TO A2-1105  
3BHK+2T (Type 3A)  
SBA : 1004 Sq.Ft.  
Carpet : 644 Sq.Ft.  
Balcony : 30 Sq.Ft.

A2-106 TO A2-1106  
3BHK+2T (Type 3A)  
SBA : 1004 Sq.Ft.  
Carpet : 644 Sq.Ft.  
Balcony : 30 Sq.Ft.

A2-107 TO A2-1107  
STUDIO (Type 3)  
SBA : 450 Sq.Ft.  
Carpet : 278 Sq.Ft.  
Balcony : 21 Sq.Ft.

A2-108 TO A2-1108  
STUDIO (Type 3)  
SBA : 443 Sq.Ft.  
Carpet : 278 Sq.Ft.  
Balcony : 21 Sq.Ft.

A2-109 TO A2-1109  
STUDIO (Type 3)  
SBA : 447 Sq.Ft.  
Carpet : 278 Sq.Ft.  
Balcony : 21 Sq.Ft.

A2-114 TO A2-1114  
1BHK+1T (Type 1A)  
SBA : 578 Sq.Ft.  
Carpet : 356 Sq.Ft.  
Balcony : 31 Sq.Ft.

A2-113 TO A2-1113  
1BHK+1T (Type 1A)  
SBA : 574 Sq.Ft.  
Carpet : 356 Sq.Ft.  
Balcony : 31 Sq.Ft.

A2-112 TO A2-1112  
1BHK+1T (Type 1A)  
SBA : 574 Sq.Ft.  
Carpet : 356 Sq.Ft.  
Balcony : 31 Sq.Ft.

A2-111 TO A2-1111  
1BHK+1T (Type 1A)  
SBA : 574 Sq.Ft.  
Carpet : 356 Sq.Ft.  
Balcony : 31 Sq.Ft.

A2-110 TO A2-1110  
1BHK+1T (Type 1A)  
SBA : 582 Sq.Ft.  
Carpet : 356 Sq.Ft.  
Balcony : 31 Sq.Ft.

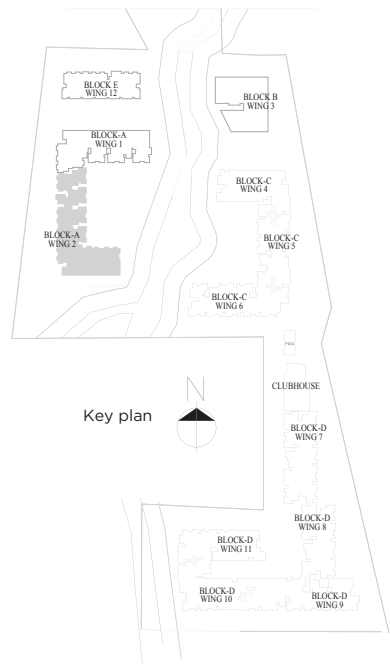

# BLOCK E - TYPICAL PLAN

E-116 TO E-1016  
STUDIO (Type 1)  
SBA : 306 Sq.Ft.  
Carpet : 176 Sq.Ft.  
Balcony : 24 Sq.Ft.

E-115 TO E-1015  
STUDIO (Type 1)  
SBA : 300 Sq.Ft.  
Carpet : 176 Sq.Ft.  
Balcony : 24 Sq.Ft.

E-114 TO E-1014  
STUDIO (Type 1)  
SBA : 300 Sq.Ft.  
Carpet : 176 Sq.Ft.  
Balcony : 24 Sq.Ft.

E-113 TO E-1013  
STUDIO (Type 1)  
SBA : 300 Sq.Ft.  
Carpet : 176 Sq.Ft.  
Balcony : 24 Sq.Ft.

E-112 TO E-1012  
STUDIO (Type 1)  
SBA : 300 Sq.Ft.  
Carpet : 176 Sq.Ft.  
Balcony : 24 Sq.Ft.

E-111 TO E-1011  
STUDIO (Type 1)  
SBA : 300 Sq.Ft.  
Carpet : 176 Sq.Ft.  
Balcony : 24 Sq.Ft.

E-110 TO E-1010  
STUDIO (Type 1)  
SBA : 300 Sq.Ft.  
Carpet : 176 Sq.Ft.  
Balcony : 24 Sq.Ft.

E-109 TO E-1009  
STUDIO (Type 1)  
SBA : 300 Sq.Ft.  
Carpet : 176 Sq.Ft.  
Balcony : 24 Sq.Ft.

E-108 TO E-1008  
STUDIO (Type 1)  
SBA : 300 Sq.Ft.  
Carpet : 176 Sq.Ft.  
Balcony : 24 Sq.Ft.

E-107 TO E-1007  
STUDIO (Type 1)  
SBA : 300 Sq.Ft.  
Carpet : 176 Sq.Ft.  
Balcony : 24 Sq.Ft.

E-106 TO E-1006  
STUDIO (Type 1)  
SBA : 300 Sq.Ft.  
Carpet : 176 Sq.Ft.  
Balcony : 24 Sq.Ft.

E-105 TO E-1005  
STUDIO (Type 1)  
SBA : 306 Sq.Ft.  
Carpet : 176 Sq.Ft.  
Balcony : 24 Sq.Ft.

E-117 TO E-1017  
STUDIO (Type 4)  
SBA : 475 Sq.Ft.  
Carpet : 299 Sq.Ft.  
Balcony : 19 Sq.Ft.

E-118 TO E-1018  
STUDIO (Type 4)  
SBA : 475 Sq.Ft.  
Carpet : 299 Sq.Ft.  
Balcony : 19 Sq.Ft.

E-101 TO E-1001  
STUDIO (Type 4)  
SBA : 475 Sq.Ft.  
Carpet : 299 Sq.Ft.  
Balcony : 19 Sq.Ft.

E-102 TO E-1002  
STUDIO (Type 4)  
SBA : 475 Sq.Ft.  
Carpet : 299 Sq.Ft.  
Balcony : 19 Sq.Ft.

E-103 TO E-1003  
STUDIO (Type 4)  
SBA : 475 Sq.Ft.  
Carpet : 299 Sq.Ft.  
Balcony : 19 Sq.Ft.

E-104 TO E-1004  
STUDIO (Type 4)  
SBA : 475 Sq.Ft.  
Carpet : 299 Sq.Ft.  
Balcony : 19 Sq.Ft.

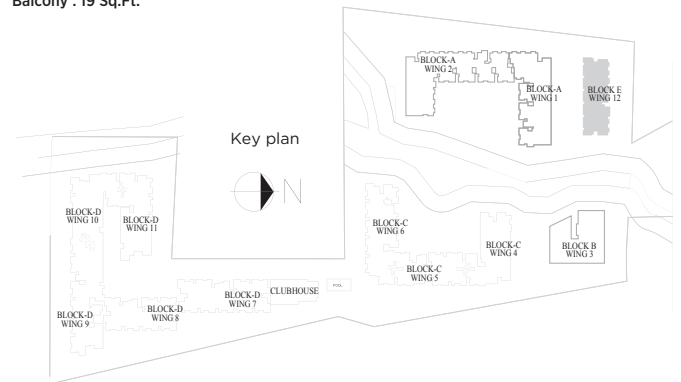

# STUDIO

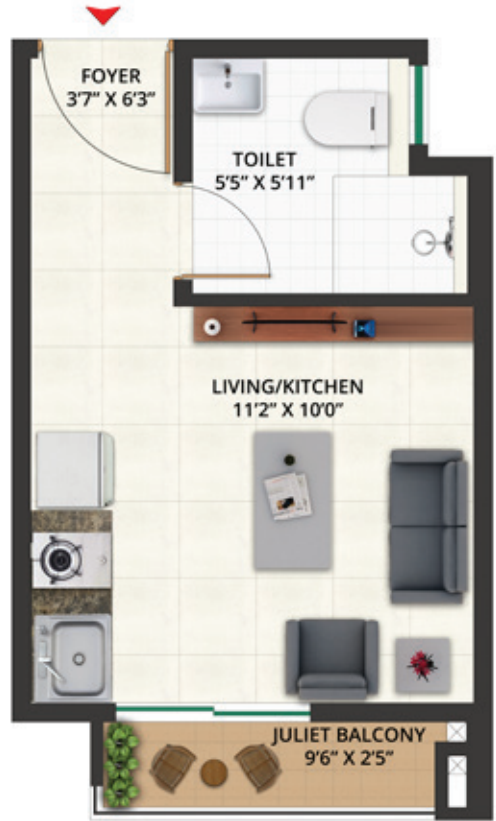
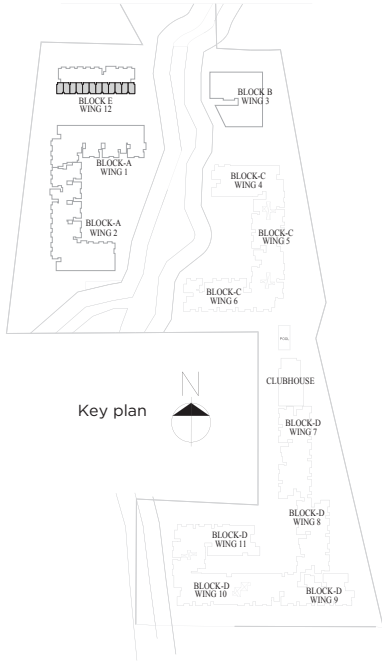

TYPE	SUPER BUILT-UP AREA	CARPET AREA	BALCONY AREA
STUDIO APARTMENT 1	300 Sq.Ft.	176 Sq.Ft.	24 Sq.Ft.

# STUDIO

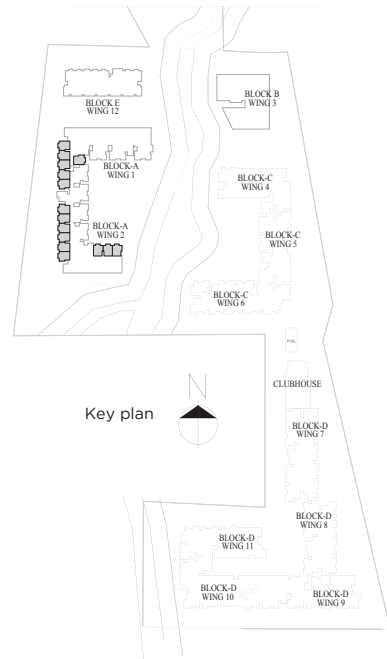

TYPE	SUPER BUILT-UP AREA	CARPET AREA	BALCONY AREA
STUDIO APARTMENT 3	449 Sq.Ft.	278 Sq.Ft.	21 Sq.Ft.

# STUDIO

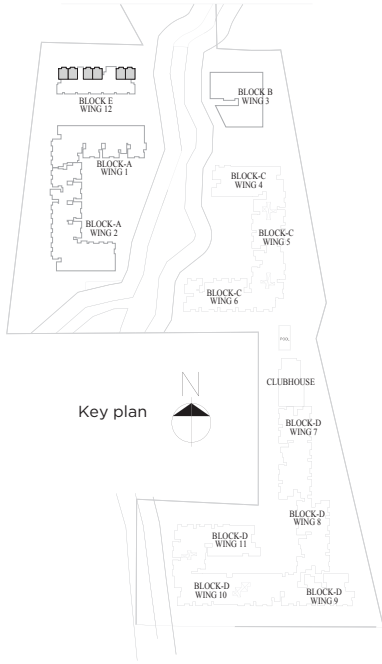

TYPE	SUPER BUILT-UP AREA	CARPET AREA	BALCONY AREA
STUDIO APARTMENT 4	475 Sq.Ft.	299 Sq.Ft.	19 Sq.Ft.

# 1 BHK+1T

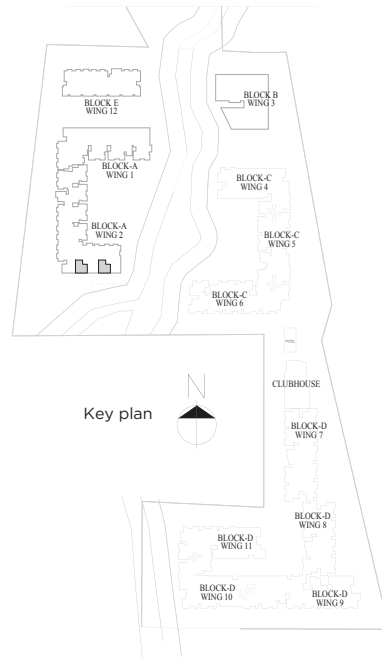

TYPE	SUPER BUILT-UP AREA	CARPET AREA	BALCONY AREA
1A	574 Sq.Ft.	356 Sq.Ft.	31 Sq.Ft.

# 1 BHK+1T

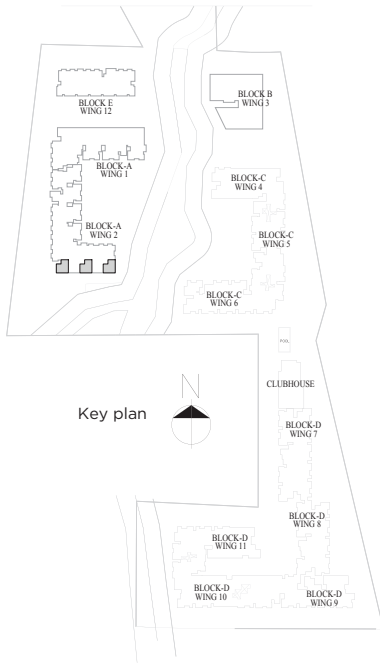

TYPE	SUPER BUILT-UP AREA	CARPET AREA	BALCONY AREA
1A	582 Sq.Ft.	356 Sq.Ft.	31 Sq.Ft.

# 1 BHK+1T

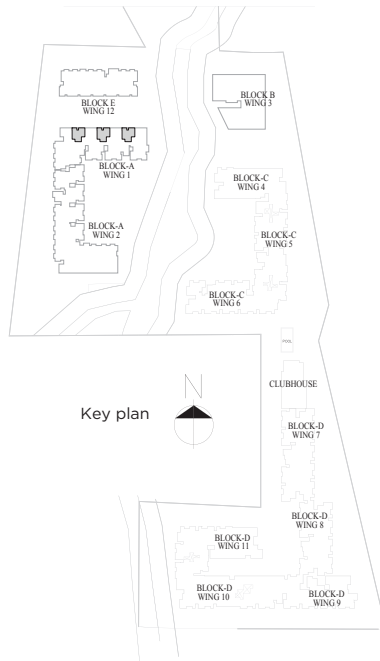

TYPE	SUPER BUILT-UP AREA	CARPET AREA	BALCONY AREA
2B	654 Sq.Ft.	388 Sq.Ft.	31 Sq.Ft.

# 1 BHK+1T

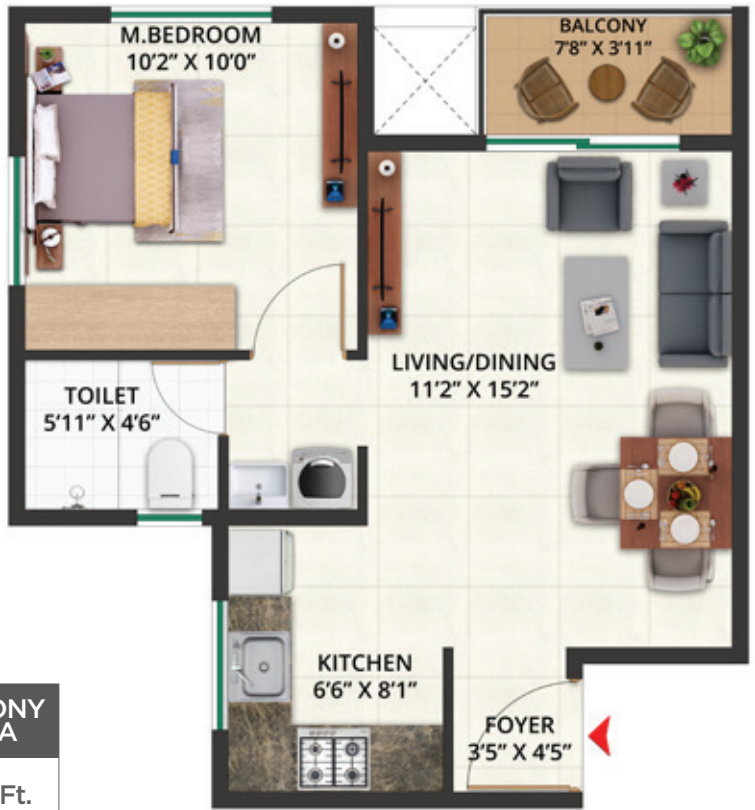
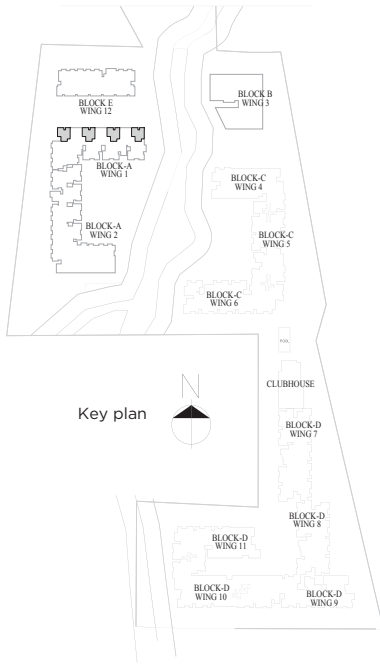

TYPE	SUPER BUILT-UP AREA	CARPET AREA	BALCONY AREA
2B	658 Sq.Ft.	388 Sq.Ft.	31 Sq.Ft.

# 3 BHK+2T

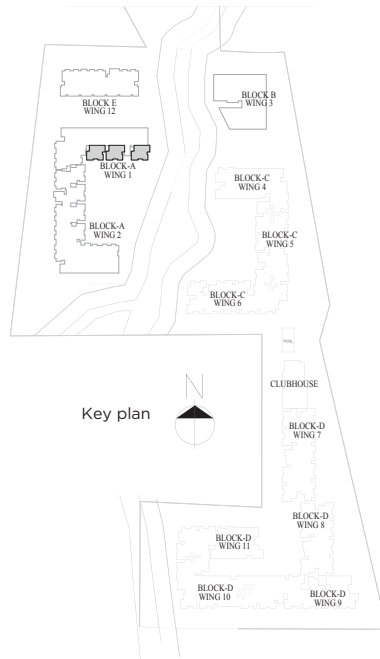

TYPE	SUPER BUILT-UP AREA	CARPET AREA	BALCONY AREA
1B	1004 Sq.Ft.	644 Sq.Ft.	30 Sq.Ft.

# 3 BHK+2T

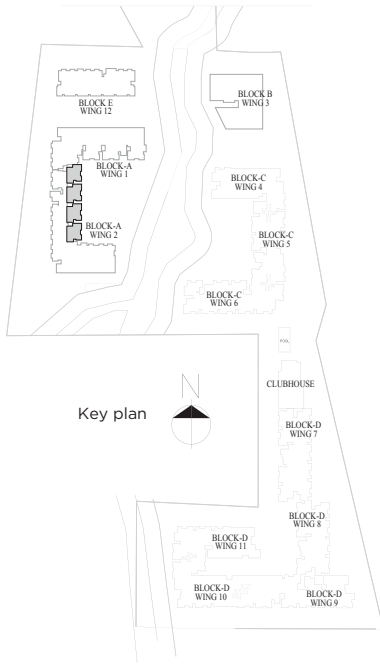

TYPE	SUPER BUILT-UP AREA	CARPET AREA	BALCONY AREA
3A	1004 Sq.Ft.	644 Sq.Ft.	30 Sq.Ft.



 **SATTVA**  
**AEROPOLIS**  
PHASE 2



Artistic Impression

EVERYTHING CLOSE. EVERYONE CLOSER.  
THE SMARTEST MOVE YOU'LL MAKE.

# AN ADDRESS ENVISIONED AND BROUGHT TO LIFE BY THE SATTVA GROUP

Built on a foundation of trust, and guided by a legacy of innovation, the Sattva Group has been shaping skylines and setting benchmarks since 1993. With more than 78 million square feet delivered, and many more projects on the horizon, it is one of the few CRISIL AA/Stable rated real estate companies in India. Their portfolio spans residences, IT parks, commercial, co-working, co-living, retail, and hospitality.

They have redefined the landscape of Indian real estate—especially in Bengaluru, where their vision helped shape the city itself. With 124 completed projects and numerous accolades to their name, what they build goes beyond structures, creating confidence and community that stand tall for years to come.



78 MILLION SQ FT COMPLETED | 71 MILLION SQ FT IN PIPELINE | 124 PROJECTS COMPLETED



**2024**  
ET BEST BRANDS  
CONCLAVE AWARD  
Best Realty Brands 2024  
Sattva Group



**2024**  
ET REAL ESTATE AWARDS  
Commercial Project - Business / IT Parks  
(South : Completed)  
Sattva Knowledge Park



**2024**  
ET REAL ESTATE AWARDS  
Iconic Project - Residential  
(South : Ongoing)  
Sattva LakeRidge



**2024**  
15TH REALTY PLUS  
CONCLAVE & EXCELLENCE AWARDS  
HYDERABAD  
Developer of the Year - Commercial  
Sattva Group



**2024**  
15TH REALTY PLUS  
CONCLAVE & EXCELLENCE  
AWARDS  
HYDERABAD  
Business Leader of the Year  
Bijay Agarwal, MD - Sattva Group



**2024**  
15TH REALTY PLUS  
CONCLAVE & EXCELLENCE AWARDS  
HYDERABAD  
Luxury Project of the Year  
Sattva LakeRidge



**2023**  
REALTY PLUS  
CONCLAVE EXCELLENCE AWARDS  
SOUTH  
Developer of the Year Commercial  
Sattva Group



**2023**  
REALTY PLUS  
CONCLAVE EXCELLENCE AWARDS  
SOUTH  
Iconic Project of the Year  
Sattva Image Tower



**2023**  
COMMERCIAL  
DESIGN AWARDS  
Hall of Fame  
Bijay Agarwal  
MD - Sattva group



**2023**  
SILICON INDIA  
REAL ESTATE AWARDS  
Residential Project of the year  
Sattva Aqua Vista



**2023**  
TIMES BUSINESS AWARDS  
HYDERABAD  
Best Residential Luxury Project  
Sattva LakeRidge



**2023**  
TIMES BUSINESS AWARDS  
BENGALURU  
Residential Project of the Year  
Sattva Park Cubix



**2023**  
ET BUSINESS EXCELLENCE  
AWARD  
2022-2023  
Best Residential Affordable  
Project of the Year  
Sattva Ashraya



**2022**  
REALTY PLUS CONCLAVE  
EXCELLENCE AWARDS, SOUTH  
Developer of the year - Commercial  
Sattva Group



**2022**  
REALTY PLUS CONCLAVE  
EXCELLENCE AWARDS 2022,  
SOUTH  
Commercial Project of the Year  
Sattva Knowledge City



**2022**  
E4M PRIDE OF INDIA BRANDS  
AWARD  
The Best of South  
Sattva Group



**2022**  
THE ECONOMIC TIMES  
REAL ESTATE CONCLAVE  
AWARDS, SOUTH  
Commercial Project - Office Building  
(Completed: Metro)  
Sattva Knowledge City



**2022**  
THE ECONOMIC TIMES  
REAL ESTATE CONCLAVE  
AWARDS, SOUTH  
Commercial Project - Business / IT Parks  
(Completed: Metro)  
Sattva Knowledge Court



**2022**  
TIMES BUSINESS AWARDS  
Bengaluru  
Best Developer Commercial  
Sattva Group



**2021**  
CONSTRUCTION WORLD  
ARCHITECT AND BUILDER  
AWARDS  
Stalwarts of the south, Bengaluru  
Sattva Group

Numbers Indicated are as on January 2025

# ONGOING PROJECTS



**Vasanta Skye**  
NH 44, Bengaluru



**Songbird**  
Budigere Main Road, Bengaluru



**Lumina**  
Yelahanka, Bengaluru



**Springs**  
Off Kanakapura Road, Bengaluru



**Forest Ridge**  
9th Phase JP Nagar, Bengaluru



**La Vita**  
Hennur Road, Bengaluru



**Ashraya**  
Bengaluru - Mysore Expressway, Bidadi



**Kaveri Siri**  
Acetate Town, Mandya



**Bliss**  
Off Budigere Road, Bengaluru



**Green Groves**  
Nelamangala, Bengaluru



**Park Cubix**  
Devanahalli Town, Bengaluru



**Aqua Vista**  
Bannerghatta Main Road, Bengaluru



**Misty Charm**  
Off Kanakapura Road, Bengaluru



**Luxuria**  
Malleshwaram, Bengaluru



**Magnificia**  
Old Madras Road, Bengaluru



**Anugraha**  
Vijayanagar Extension, Bengaluru



**Navratna Residency**  
Avinashi Road, Coimbatore



**HM Royal**  
Kondhwa (opposite Talab factory), Pune



**LakeRidge**  
Kokapet, Hyderabad



**Water's Edge**  
Sancoale, Goa



#### SITE ADDRESS

##### **SATTVA AEROPOLIS PHASE II**

Udayagiri Village, kasaba hobli, Devanhalli Taluk,  
National Highway No.7, Devanhalli, Bengaluru Rural  
Karnataka - 562157

**1800 121 3344**

---

#### CORPORATE OFFICE

##### **SATTVA GROUP**

Sattva Windsor, No. 3, Ulsoor Road,  
Bengaluru - 560 042, INDIA.

Tel: +91 80 42699000

Fax: +91 80 42699011



[www.sattvagroup.com](http://www.sattvagroup.com)

BENGALURU • HYDERABAD • MUMBAI • PUNE • CHENNAI  
KOLKATA • GOA • COIMBATORE

RERA NO. - PRM/KA/RERA/1250/303/PR/110522/004869

This is not an offer, an invitation to offer and/or commitment of any nature. This contains artistic impressions and stock images for illustrative purpose and no warranty is expressly or impliedly given that the completed development will comply in any degree with such artist's impression as depicted. All specifications of the flat/plot shall be as per the final agreement between the parties. Recipients are advised to use their discretion in relying on the information/amenities described/shown therein.

