

DEMARCATON AND DEVELOPMENT PURPOSE ONLY

AREA STATEMENT									
Sl.No	Village	Sy No.	Total Area Acres	Kharab Gunta	Remaining Extent Acres	Conversion Extent Gunta	Conversion Order Number & Dated		
1	Bommenahalli	60/2	00 38	00 00	38 00	38 00	APPLICATION NO.624252 Dated-14-03-2024		
2		60/3	00 38	00 00	38 00	38 00	APPLICATION NO.624271 Dated-14-03-2024		
3		61/10	00 26	01 00	25 00	25 00	APPLICATION NO.140916 Dated-13-01-2020		
4		63	02 10	02 02	08 02	08 02	APPLICATION NO.709441 Dated-14-11-2024		
5		64/2	02 15	06 02	09 02	09 02	APPLICATION NO. 140933 Dated-13-01-2020		
6		65/2	01 07	01 01	06 01	06 01	APPLICATION NO.624255 Dated-05-03-2024		
7		65/3	01 14	01 01	13 01	13 01	APPLICATION NO.624263 Dated-12-03-2024		
8		65/5	00 13.5	0.5 00	13 00	13 00	APPLICATION NO.631659 Dated-16-03-2024		
9		65/6	00 13.5	0.5 00	13 00	13 00	APPLICATION NO.631656 Dated-16-03-2024		
TOTAL AREA		10 15 12 10 03 10 03							

BOMMENAHALLI VILLAGE RESIDENTIAL ODD SITE AREA		
SL.NO	Site No.	Area in Sq.Mt.
1	2	130.21
2	4	116.86
3	6	163.32
4	20	127.55
5	21	156.62
6	22	145.36
7	23	106.71
8	24	166.79
9	25	129.14
10	26	121.73
11	27	114.32
12	28	124.36
13	37	139.18
14	46	154.47
15	47	190.71
16	48	141.13
17	49	139.25
18	50	137.37
19	51	135.48
20	52	120.00
21	53	129.37
22	54	122.65
23	55	119.68
24	57	159.71
25	58	138.31
26	60	203.20
27	62	193.78
28	63	190.80
29	64	133.17
30	65	124.65
31	66	111.50
32	76	171.67
33	86	206.73
34	87	156.69
35	98	128.19
36	99	156.04
37	108	131.66
38	109	159.64
39	117	163.04
40	118	146.58
41	126	182.35
42	127	133.22
43	136	117.59
44	137	101.13
45	146	118.84
TOTAL		6460.75
COMMERCIAL ODD SITE AREA		
SL.NO	Site No.	Area in Sq.Mt.
1	1	483.18

CA DETAILS	
CA No.	AREA IN SQMT
CA-1	879.18
CA-2	1134.43
TOTAL	2013.61

PARK DETAILS	
PARK No.	AREA IN SQMT
PARK - 1	964.98
PARK - 2	214.78
PARK - 3	249.38
PARK - 4	87.57
PARK - 5	197.01
PARK - 6	2262.79
TOTAL	3976.51

RESIDENTIAL PLOT DETAILS				
SL NO.	DIMENSIONS	SITE NUMBERS	TOTAL	Total Area In Sqmt
1.	9.0m x 12.0m	72, 73, 74, 75, 101, 105, 106, 107, 115, 116, 119, 120, 128, 134, 135, 138, 139.....	17	1836.00
2.	9.0m x 15.0m	29, 30, 31, 32, 33, 34, 35, 36, 38, 39, 40, 41, 42, 43, 44, 45, 56, 59, 77, 78, 79, 80, 81, 82, 83, 84, 88, 89, 90, 91, 92, 93, 94, 95, 96, 97.....	36	4860.00
3.	12.0m x 15.0m	7, 8, 9, 10, 11, 12, 13, 14, 15, 16, 17, 18, 19, 61, 85.....	15	2700.00
4.	12.0m x 12.0m	3, 5, 67, 68, 69, 70, 71, 100, 102, 103, 104, 110, 111, 112, 113, 114, 121, 122, 123, 124, 125, 129, 130, 131, 132, 133, 140, 141, 142, 143, 144, 145.....	32	4608.00
5.	Odd Sites*	2, 4, 6, 20, 21, 22, 23, 24, 25, 26, 27, 28, 37, 46, 47, 48, 49, 50, 51, 52, 53, 54, 55, 57, 58, 60, 62, 63, 64, 65, 66, 76, 86, 87, 98, 99, 108, 109, 117, 118, 126, 127, 136, 137, 146.....	45	6460.75
TOTAL SITES			145	20464.75

COMMERCIAL PLOT DETAILS				
DIMENSIONS	SITE NUMBERS	TOTAL	TOTAL AREA IN SQM	
Commercial Odd Sites*	1.....	01	483.18	

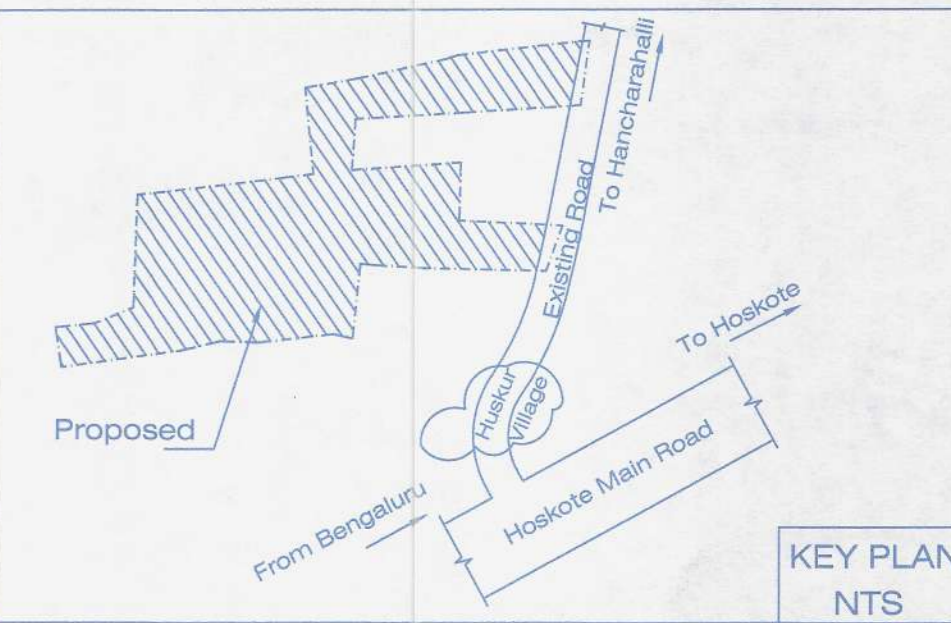
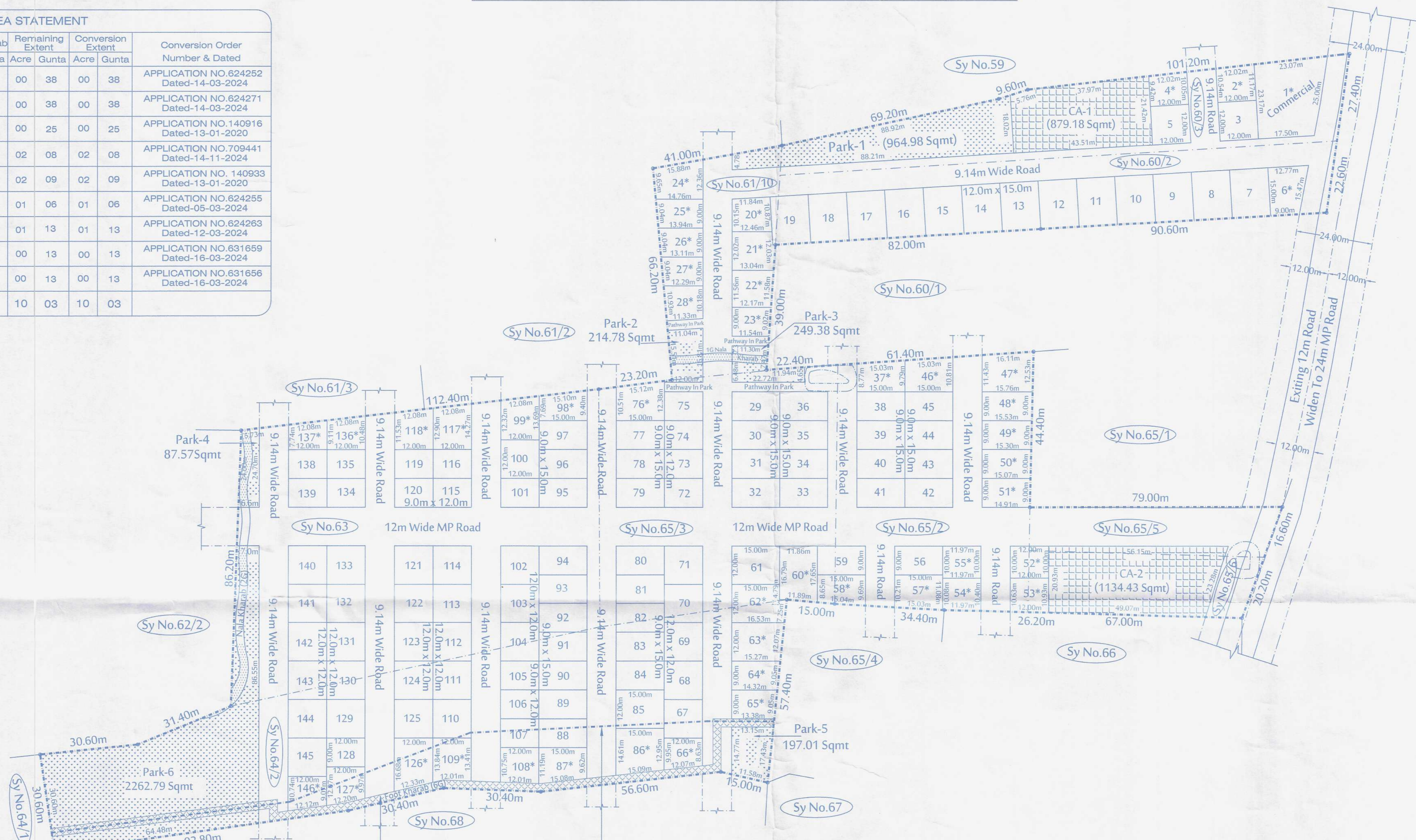

SCALE - 1:750
ALL DIMENSIONS ARE IN METER

LEGENDS	
LAYOUT BOUNDARY
REVENUE BOUNDARY	-----
PARK
CA
NALA KHARAB LINE
ROAD KHARAB LINE

NOTE:-
As Per Revenue Record Total Extent is 10Acres - 03Guntas (Excluded Of 12G 'B' Kharab) But Physically Available Land IS = 9A-33G

-LAND USE ANALYSIS:-			
SL.NO	DESCRIPTION	AREA IN SQMT	%
1	RESIDENTIAL	20464.75	51.47
2	COMMERCIAL	483.18	01.22
3	PARK	3976.51	10.00
4	C A	2013.61	05.06
5	ROADS	12822.15	32.25
TOTAL AREA		39760.20	100.00

PLOT DETAILS		
SL.NO	SITE DIMENTIONS	SITES NO
1	9.0m x 12.0m	17
2	9.0m x 15.0m	36
3	12.0m x 15.0m	15
4	12.0m x 12.0m	32
5	ODD SITES*	46
TOTAL AREA		146

OWNERS :
KONIG HOMES
Rep by . Managing Partner
SATISH BOGOLLU

ENGINEER'S SIGNATURE
For FWD Architects
(BY Name of Main Engineer)
Architect
Regn No. CA/2009/45904

TITLE
PROPOSED RESIDENTIAL DRAFT LAYOUT PLAN IN
SY.NO.60/2, 60/3, 61/10, 63, 64/2, 65/2,
65/3, 65/5, 65/6 OF BOMMENAHALLI VILLAGE,
BIDARAHALLI HOBLI, BENGALURU EAST TALUK.

SANCTIONING AUTHORITY
*Provisional Approval
For Demarcation and Development
Purpose only*

ಸರ್ಕಾರ ಅಧೀನದಲ್ಲಿ ಸಂಖ್ಯೆ ಸಂಖ್ಯೆ 24 ಪಾನನ 1415
ಗೌರವಾನ್ವಿತ, ದಿನಾಂಕ 10.09.2015 ರಂತೆ ಪ್ರಾಧಿಕಾರದ
ದಿನಾಂಕ 06.01.2015 ರಂದು ನಡೆದ '105' ನೇ
ಸಭೆಯ ವಿಷಯ ಸಂಖ್ಯೆ 15 ರಲ್ಲಿ ತೆಗೆದುಕೊಂಡ
ನಿರ್ಣಯಕ್ಕೆ ಅನುಸಾರವಾಗಿ ಹಾಗೂ ಪತ್ರ ಸಂಖ್ಯೆ ಜೊಂಟಿಯಾ
140.1.7.1002-24 ದಿನಾಂಕ :
20.02.2015 ರಲ್ಲಿನ ನಿಬಂಧನೆಗಳನ್ವಯ ಹಾಗೂ ಈ ವಸತಿ
ವಿನ್ಯಾಸ ಪತ್ರವನ್ನು ಕೈರದಲ್ಲಿ ಅಭಿವೃದ್ಧಿಪಡಿಸುವ ಸಲುವಾಗಿ
(For Demarcation and Development
Purpose only) ಮಾಡಿ ಅನುಮೋದಿಸಲಾಗಿದ್ದು "ಈ ಪತ್ರ
ಅಧಾರದ ಮೇಲೆ ನಿವೇಶನಗಳನ್ನು ಮಾಡಲು ಮಾನ್ಯವಾಗಿದೆ"

ASSISTANT DIRECTOR OF TOWN & COUNTRY PLANNING
DEPUTY DIRECTOR OF TOWN & COUNTRY PLANNING
JOINT DIRECTOR OF TOWN & COUNTRY PLANNING & MEMBER SECRETARY
HOSKOTE PLANNING AUTHORITY, HOSKOTE