



SOUL OF THE
SEASONS

— BY NBR GROUP —

NBR



IMAGINE A PLACE
WHERE LIFE IS
WITH NATURE...

WELCOME TO
A LIFE
NURTURED
BY NATURE

We believe every creation must echo the Earth's very heartbeat. Inspired by GAIA's ancient philosophy—the Earth, a living, breathing organism—we embrace life's profound, interwoven dance. Each endeavor, especially our maiden residential development, The Soul of the Seasons, stands as a sacred tribute to this bond. Here, nature's elements converge to shape not merely homes, but sanctuaries where harmonious living breathes.



SOUL OF THE
SEASONS

— BY NBR GROUP —





SOUL OF THE SEASONS
— BY NBR GROUP —

The five elements namely, Earth, Water, Fire, Air, and Ether, come together to shape our world, creating a harmonious balance that connects us to life, growth, and endless possibilities.

Their interplay inspires movement, energy, and openness, guiding every moment with a sense of unity and purpose.



INSPIRED BY — ETHER —

our philosophy is to create open, expansive spaces that foster a sense of freedom and community.





INSPIRED BY — AIR —

our projects are designed with abundant natural ventilation and breezy open spaces.



INSPIRED BY — FIRE —

our spaces are designed to foster a vibrant community where every interaction feels warmer.





INSPIRED BY — WATER —

we actively design for seamless flow,
integrating preservation as a cornerstone.



INSPIRED BY — EARTH —

and its grounding energy,
land preservation and restorative features
are a vital part of our project.



A BENGALURU GEM,
EVERGREEN
 IN EVERY WAY.



UPCOMING INFRASTRUCTURE

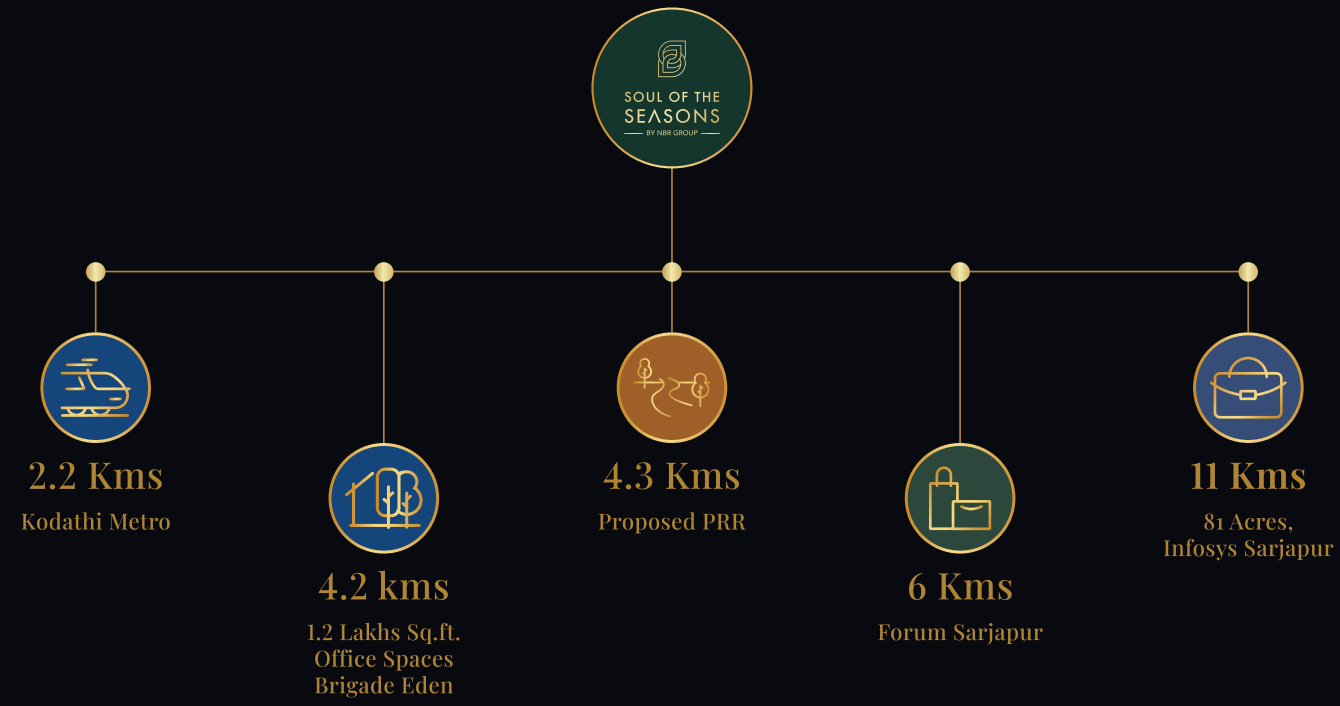

CONNECTIVITY



TECH PARKS

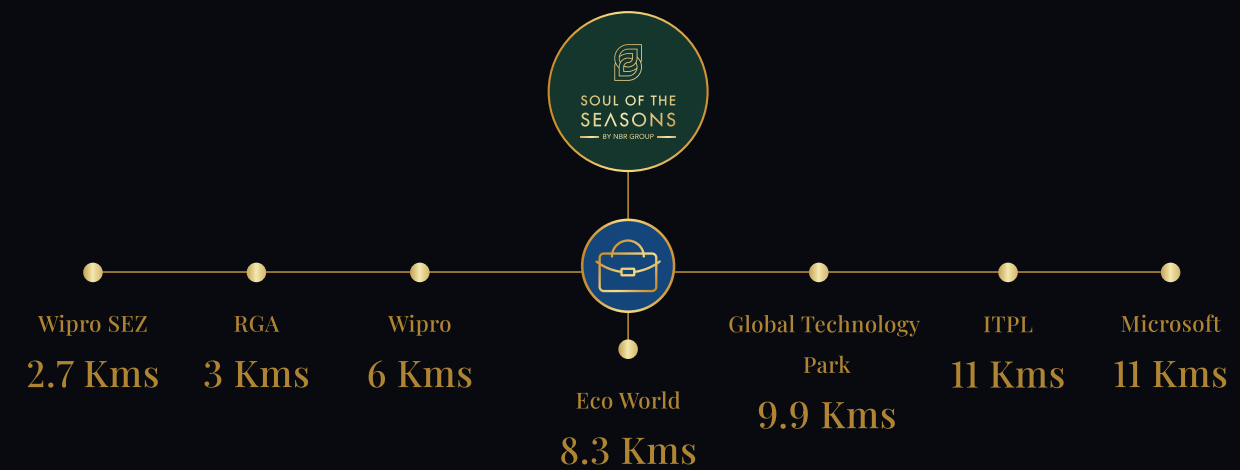

HOSPITALS





At NBR Soul of the Seasons, four distinctive towers are named to reflect the timeless beauty of nature's cycles. Each tower embodies a unique season—from spring's vibrancy to winter's tranquillity underscoring a design philosophy where modern luxury harmonizes with the natural world.

PROJECT HIGHLIGHTS

TOWERS

4

APARTMENTS

3BHK

OPEN SPACES

88 %

LOCATION

SARJAPUR ROAD
GUNJUR

Experience resort-style living across four magnificent towers, each with its own elegant lobby. This design offers a sense of exclusivity and personalized service.

The grand clubhouse is the heart of our community—a central hub for wellness, recreation, and social connection. It's an extension of your home, perfect for unwinding and connecting with neighbours.

BLOSSOM

Tower - 1

B+G+22

SOLSTICE

Tower - 2

B+G+24

DRIZZLE

Tower - 3

2B+G+25

IVORY

Tower - 4

2B+G+26

THE SEASON'S HEART

CLUBHOUSE

2B+G+2+TERRACE

A HOME IS
THE SACRED
REFUGE OF
MIND, BODY,
AND SPIRIT.



THE INVITING HEART
OF THE HOME.





LANDSCAPE MASTERPLAN



DEVARA LAKE



RESORT LIVING

R-ROOTSCAPES		E-EARTHSPRINGS		S- SOULFUL ARRIVALS		O- OASISPACE		R- RUNFIELDS		T-TRANILNEST	
5	ORCHARDS	23	SWIMMING POOL	1	GATE COMPLEX	11	SIT OUT NOOK	17	PICKLEBALL COURT	3	BAZAAR
6	AROMATIC GROOVE	22	KID'S POOL	2	ENTRANCE VISTA	20	PEBBLE SEATS	36	BASKETBALL COURT	4	EXHIBITION LAWN
39	DENSE PLANTING	53	LILY POOL	8	CENTERAL ROUND ABOUT	37	BOOMERANG SEATING PAVILION	31	BANQUET LAWN	31	BANQUET LAWN
43	FLOWER GARDEN	30	REFLECTING WATER FEATURE	12	AVENUE PLANTING	42	LOOKOUT PAVILION	44	SKATING RINK	34	OPEN ABLE IENNIS
48	FRUIT GROOVE	7	WATER FEATURE PAVILION	61	BICYCLE PARKING	46	GATHERING ZONE	45	FITNESS COURT	35	CHESS PLAY
51	MEDITATION LAWN	21	POOL DECK	33	FEATURE WALL	47	SENIOR CITIZEN PAVILION	54	NATURE WALK	38	PROJECTOR WALI
14	TOWER PLANTERS	24	CHANGING ROOM	50	BUS WAITING AREA	60	KID'S SEATING	55	CRICKET PITCH	41	MULTIPURPOSE LAWN
10	PET PARK	62	POOL PAVILION	13	TOWER ENTRY PORTAL	16	READING NOOK	56	MULTIPURPOSE SPORTS FIELD	49	REFLEXOLOGY PATH
19	TOWER 1 LAWN	32	WATER FEATURE	27	CLUB DROP-Off	57	AMPHITHEATRE	58	TENNIS COURT	40	DECK WALK
18	DENSE PLANTING GROVE	25	OPEN SHOWER	9	PARKING			59	HOPSCOTCH/ TOT LOT	52	WOODLAND BOARD WALK
				28	CLUB ENTRANCE VISTA			15	KID'S PLAY	63	CLUB HOUSE
				28	SERVICE ENTRY			26	JOGGING TRACK		

UNIT 1 - 3BHK - 3T - TYPE A

Saleable area
1825 SQFT

Carpet area as per RERA
1128.49 SQFT

Balcony area
167.59 SQFT

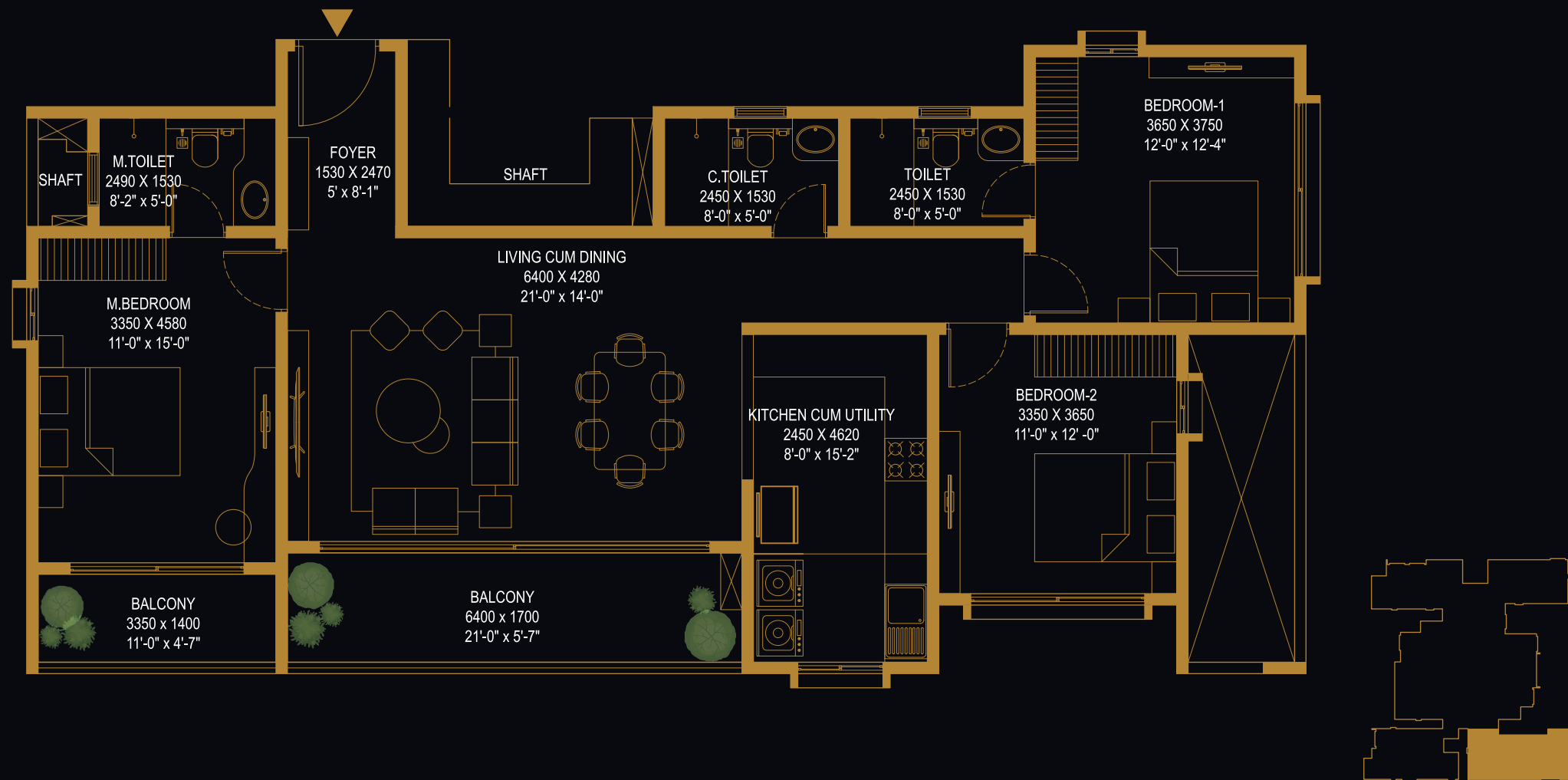

UNIT 2 - 3BHK - 3T - TYPE B

Saleable area
1826 SQFT

Carpet area as per RERA
1148.19 SQFT

Balcony area
150.26 SQFT

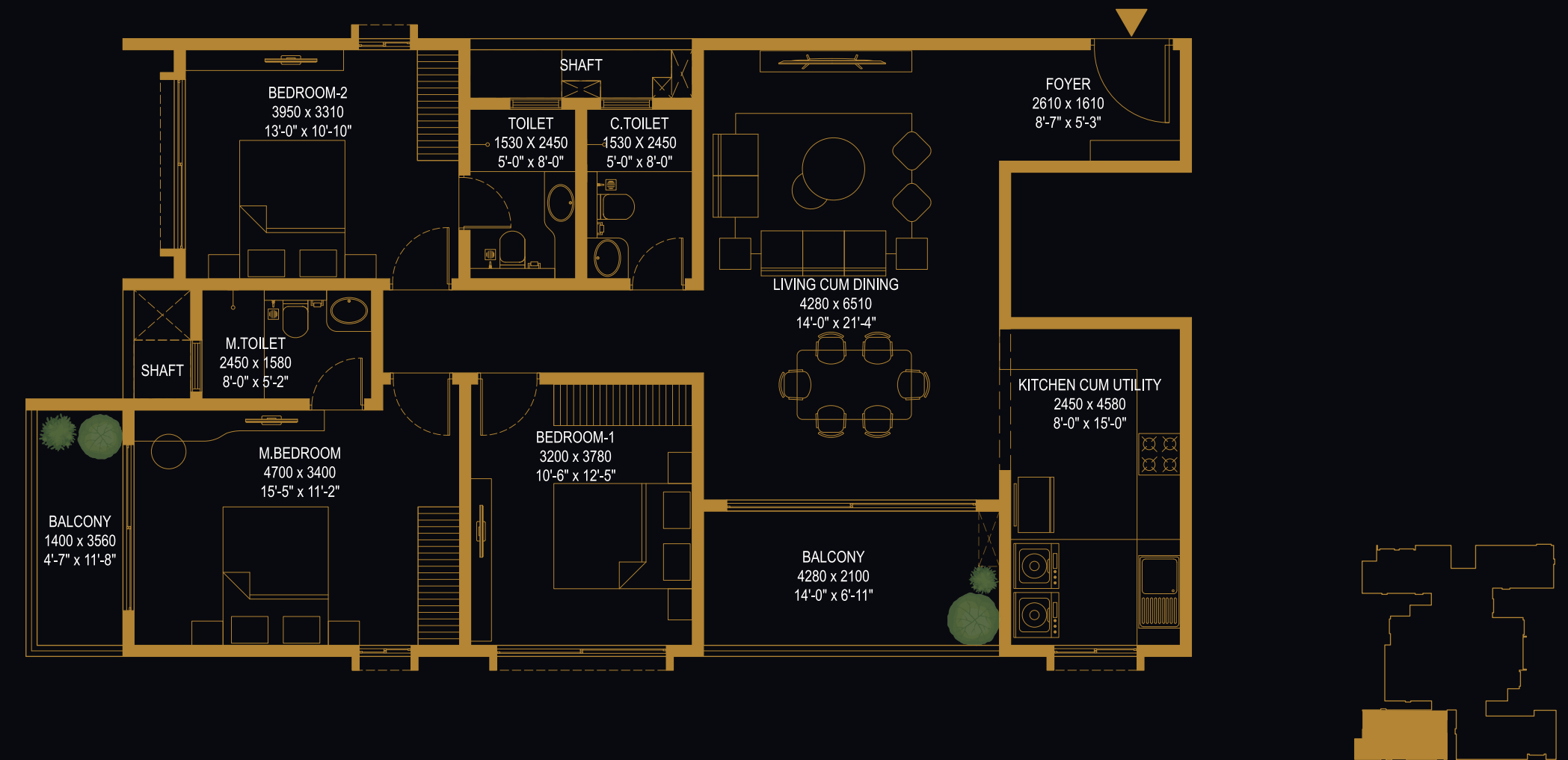

UNIT 3 - 3BHK - 3T - TYPE C

Saleable area
1628 SQFT

Carpet area as per RERA
1047.11 SQFT

Balcony area
101.40 SQFT



UNIT 3 - 3BHK - 3T - TYPE C WITH TRIPLE HEIGHT BALCONY

Saleable area
1690 SQFT

Carpet area as per RERA
1047.11 SQFT

Balcony area
148.97 SQFT



UNIT 4 - 3BHK - 3T - TYPE D

Saleable area
1643 SQFT

Carpet area as per RERA
1082.74 SQFT

Balcony area
90.42 SQFT

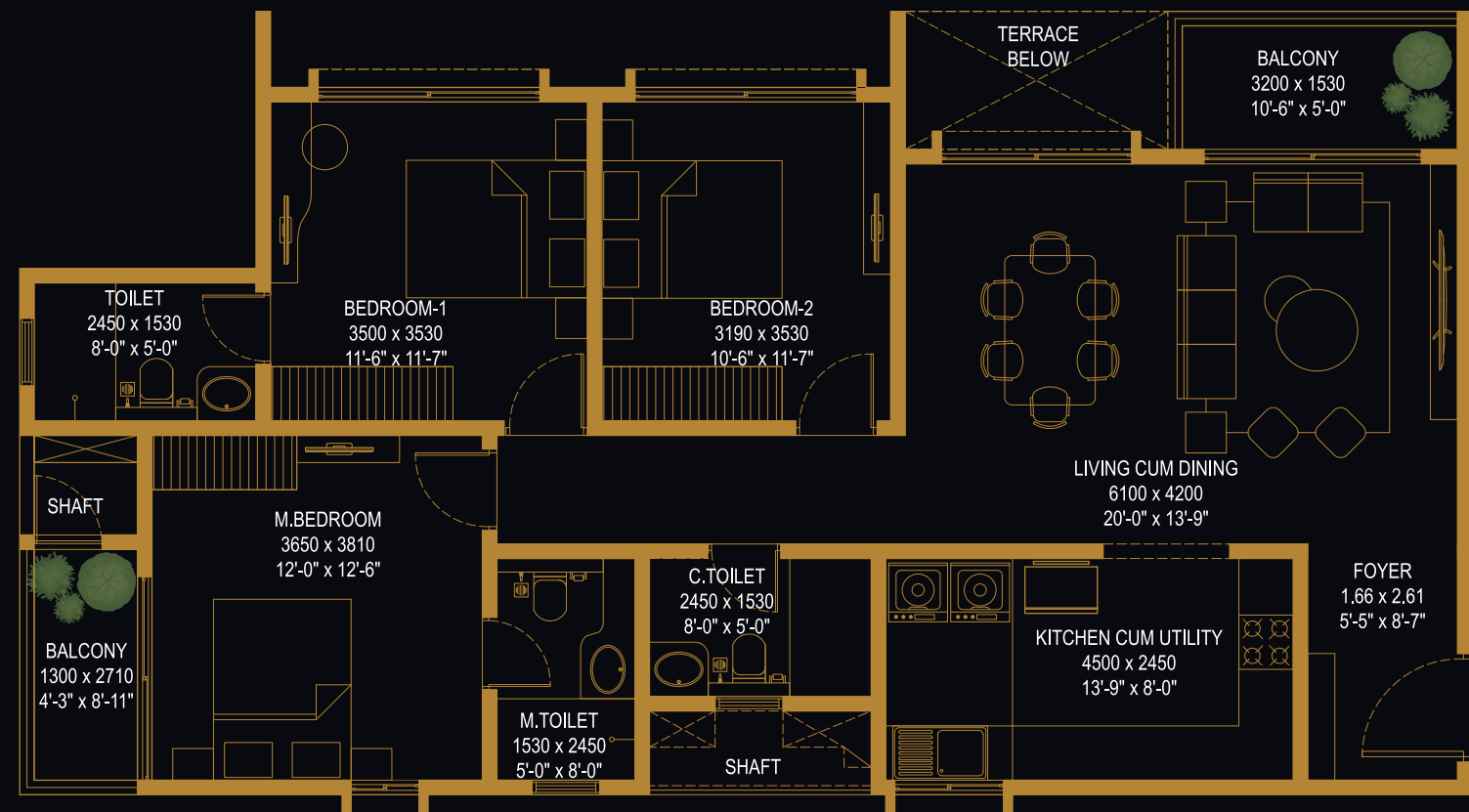

UNIT 4 - 3BHK - 3T - TYPE D WITH TRIPLE HEIGHT BALCONY

Saleable area
1705 SQFT

Carpet area as per RERA
1082.74 SQFT

Balcony area
137.99 SQFT

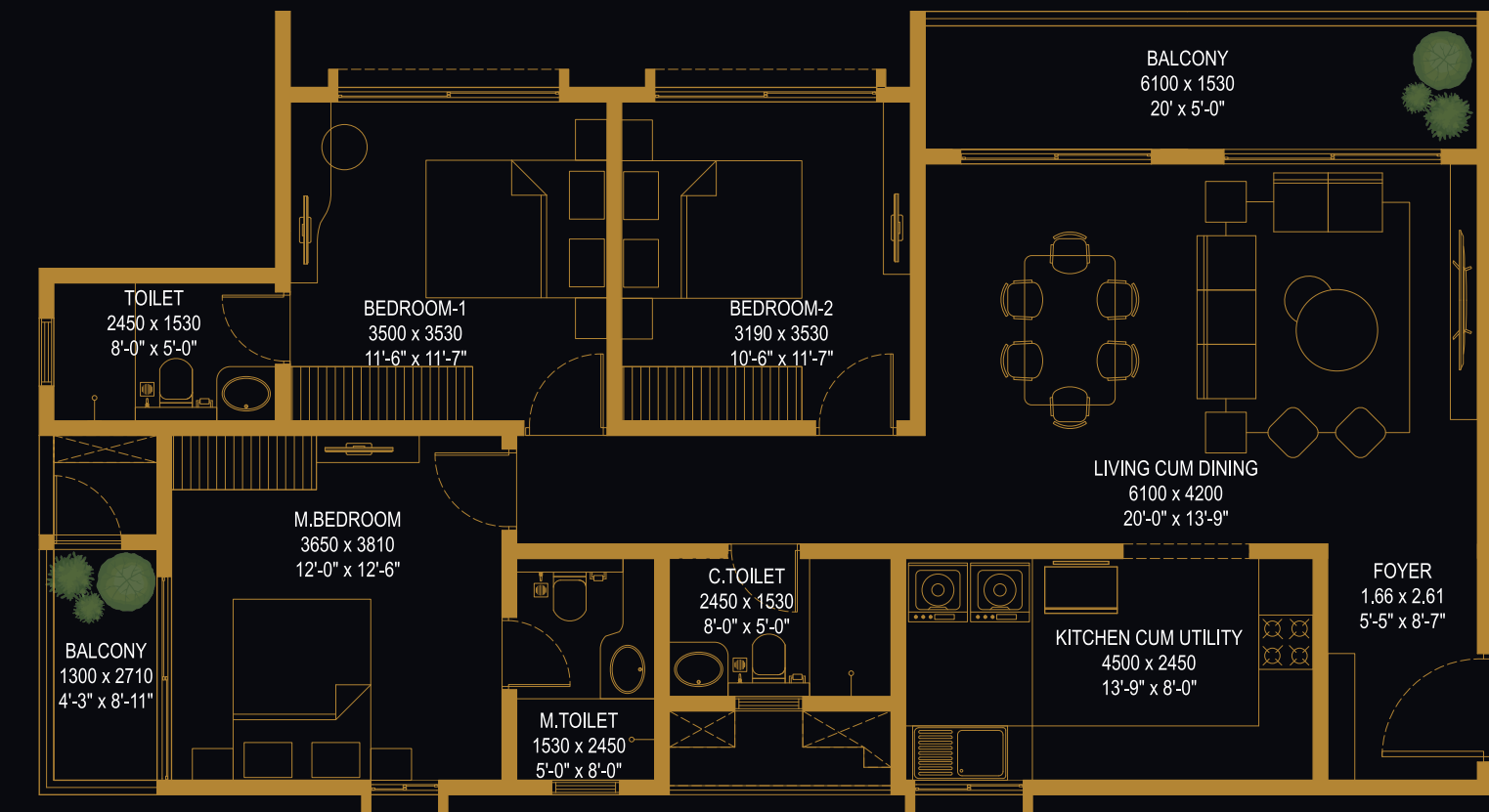

UNIT 5 - 3BHK - 3T - TYPE E

Saleable area
1618 SQFT

Carpet area as per RERA
1052.39 SQFT

Balcony area
91.49 SQFT

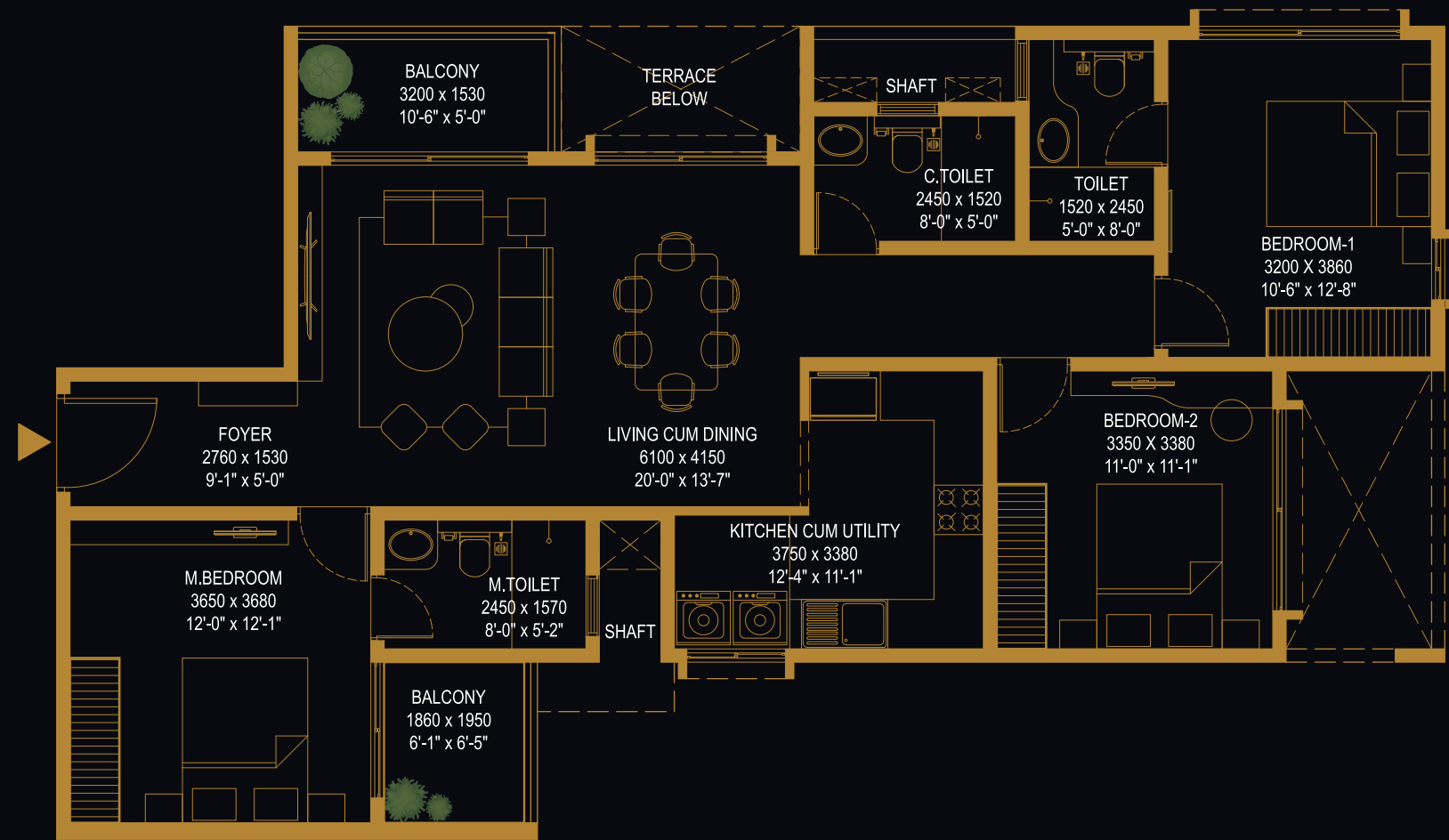

UNIT 5 - 3BHK - 3T - TYPE E WITH TRIPLE HEIGHT BALCONY

Saleable area
1679 SQFT

Carpet area as per RERA
1052.39 SQFT

Balcony area
139.07 SQFT

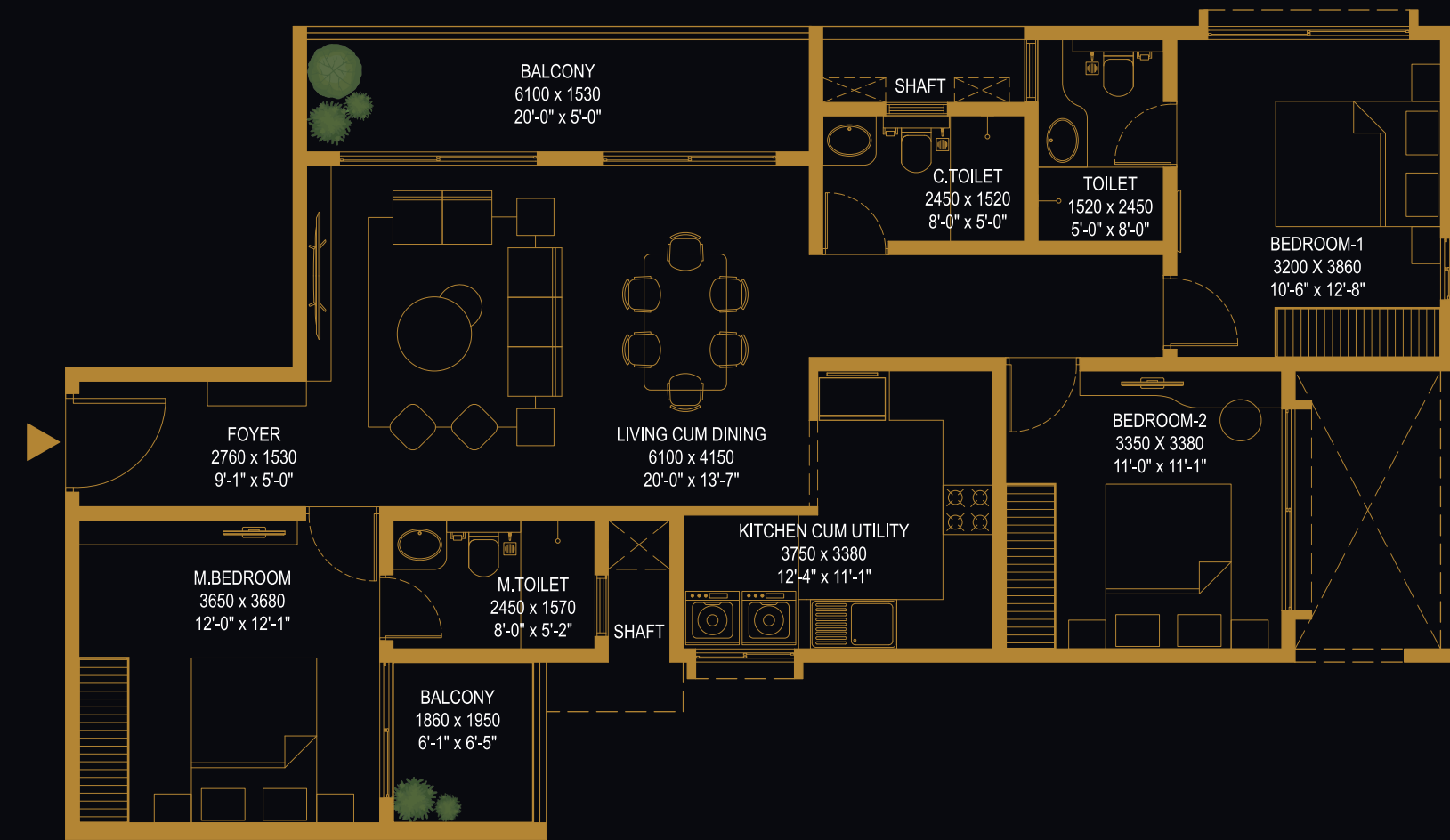

UNIT 6 - 3BHK - 2T - TYPE F

Saleable area
1446 SQFT

Carpet area as per RERA
947.76 SQFT

Balcony area
77.07 SQFT

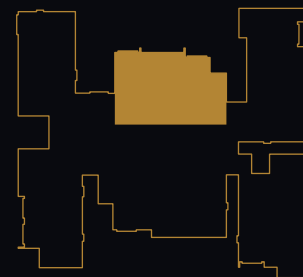
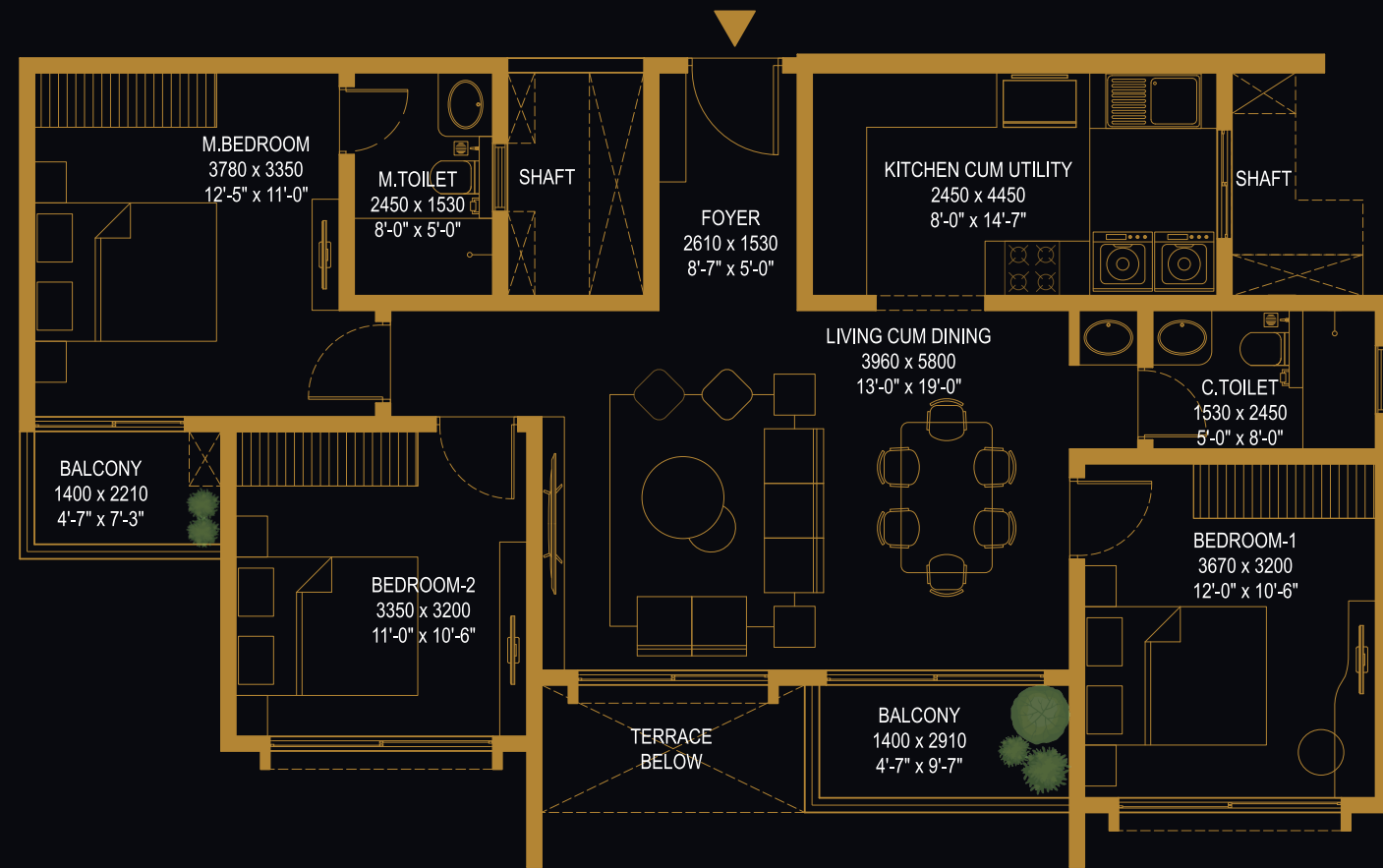

UNIT 6 - 3BHK - 2T - TYPE F WITH TRIPLE HEIGHT BALCONY

Saleable area
1503 SQFT

Carpet area as per RERA
947.76 SQFT

Balcony area
120.66 SQFT

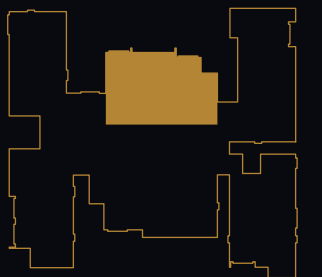
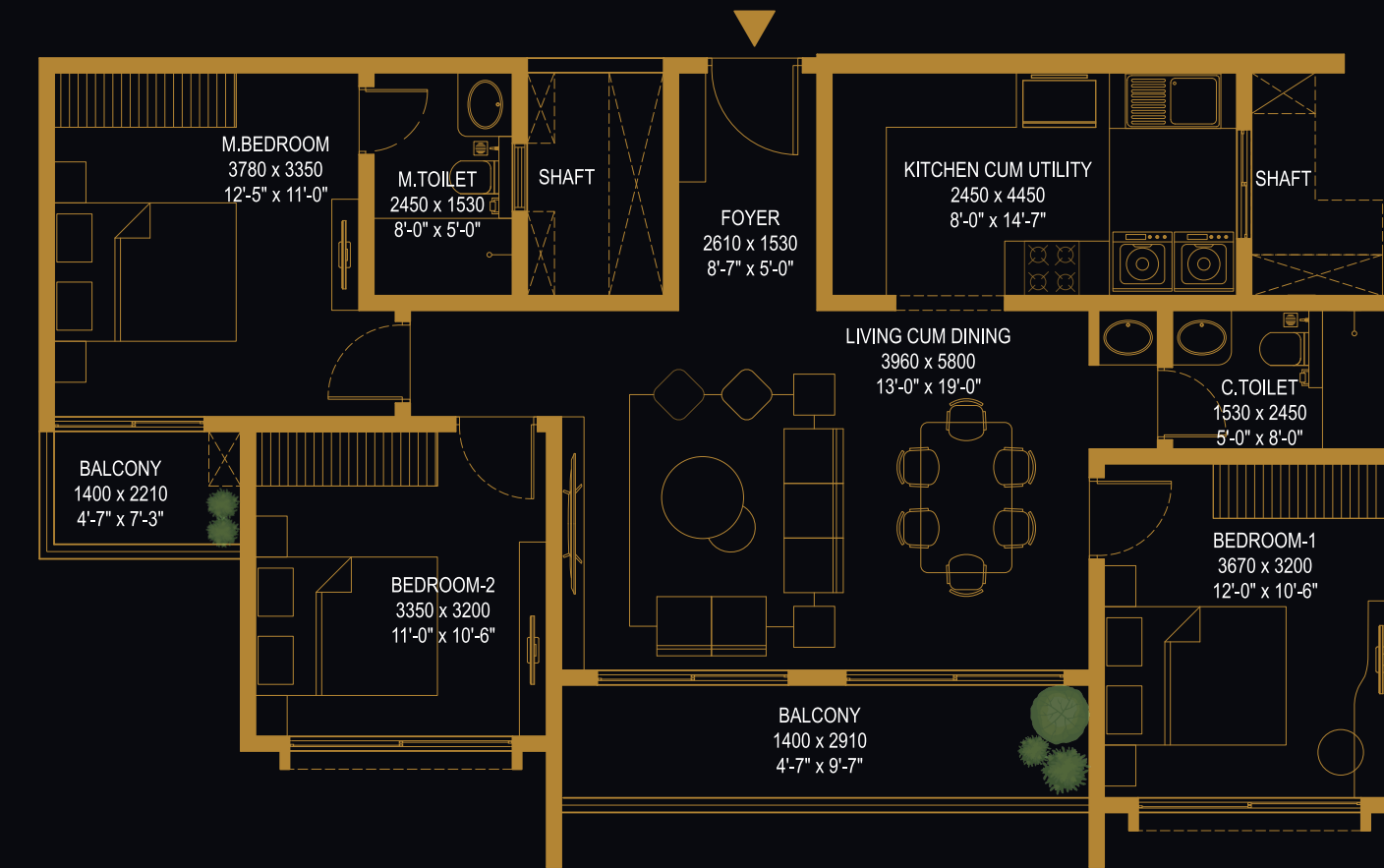



MILESTONES

1998 NBR GROUP

Founded in 1998, NBR Group was established by Mr. Nagabhushana Reddy, now the Founder, CEO and Managing Director, to transform the way homebuyers perceive plotted development.

2010 NBR MEADOWS

Spread across 35 acres with 655 HNTDA approved villa plots, NBR Meadows offers a serene, nature-shaped lifestyle with modern amenities and excellent connectivity, delivering the perfect blend of tranquillity, convenience and strong growth potential.

2010 NBR LAKE VIEW

With the response of NBR Homes, a few more options were created for the busy people - bringing them closer to Electronic City Phase 1 and the Hosur Main Road.

2011 NBR GREEN VALLEY

It is no secret that Hosur is enjoying a lot of attention from investors in recent times given the many advantages of the location and so, came the NBR Green Valley.

2011 NBR GOLDEN VALLEY

It offers spacious villa plots along Bagalur Hosur Road, combining green open surroundings with modern infrastructure and easy connectivity for a peaceful yet well-connected lifestyle.

2015 NBR TRIFECTA

Located in the charming Sarjapur-Hosur Road belt, NBR Trifecta offers a variety of plots that are HNTDA converted.

2018 NBR HILLS VIEW

Who doesn't want to escape the madding crowd—especially when living in a vibrant metro like Bangalore? Crafted for peace, serenity, and quality family time, NBR Hills View is your perfect retreat, located in the lush Nandi Hills.



Your Journey
to Serenity Begins.

As you turn the final page, know that NBR Soul of the Seasons is more than just a collection of homes; it is a meticulously crafted philosophy brought to life. Here, every detail, from the grand entrance to the intimate corners of your residence, is designed to resonate with the Earth's rhythm and elevate your everyday.

We invite you to step into a life where the stillness of nature embraces you, where modern elegance meets timeless serenity, and where the soul finds its true home amidst the harmony of the seasons. Discover a place where you don't just live, but truly thrive, connected to both comfort and the quiet wisdom of GAIA.

Welcome home to NBR Soul of the Seasons—where every moment is an invitation to live beautifully.



SOUL OF THE
SEASONS
— BY NBR GROUP —

27/3 Kachamaranahalli, Varthur Hobli,
Gunjur - Kodati Rd, opp. Sri Sri Ravishankar Vidya Mandir School
East Gate, Bengaluru, Karnataka 560087

8884610800 | www.nbrgroup.in