



THE
IVORY TERRACES

— WHITEFIELD —

EXPANSIVE 2 & 3 BED RESIDENCES



THE
IVORY TERRACES
—WHITEFIELD—

Inspired by Whitefield's old-world charm and new-age energy, this home is a gentle blend of timeless elegance and modern comfort. It's a space where memories grow, laughter echoes, and every room feels like it already knows you.



RERA NO. PRM/KA/RERA/1251/446/PR/181122/005469

A Story That Began 150 Years Ago

Before the city took shape, this land was a wild sanctuary.

A colonial farmhouse stood quietly, cradled by nature's embrace.

PAST

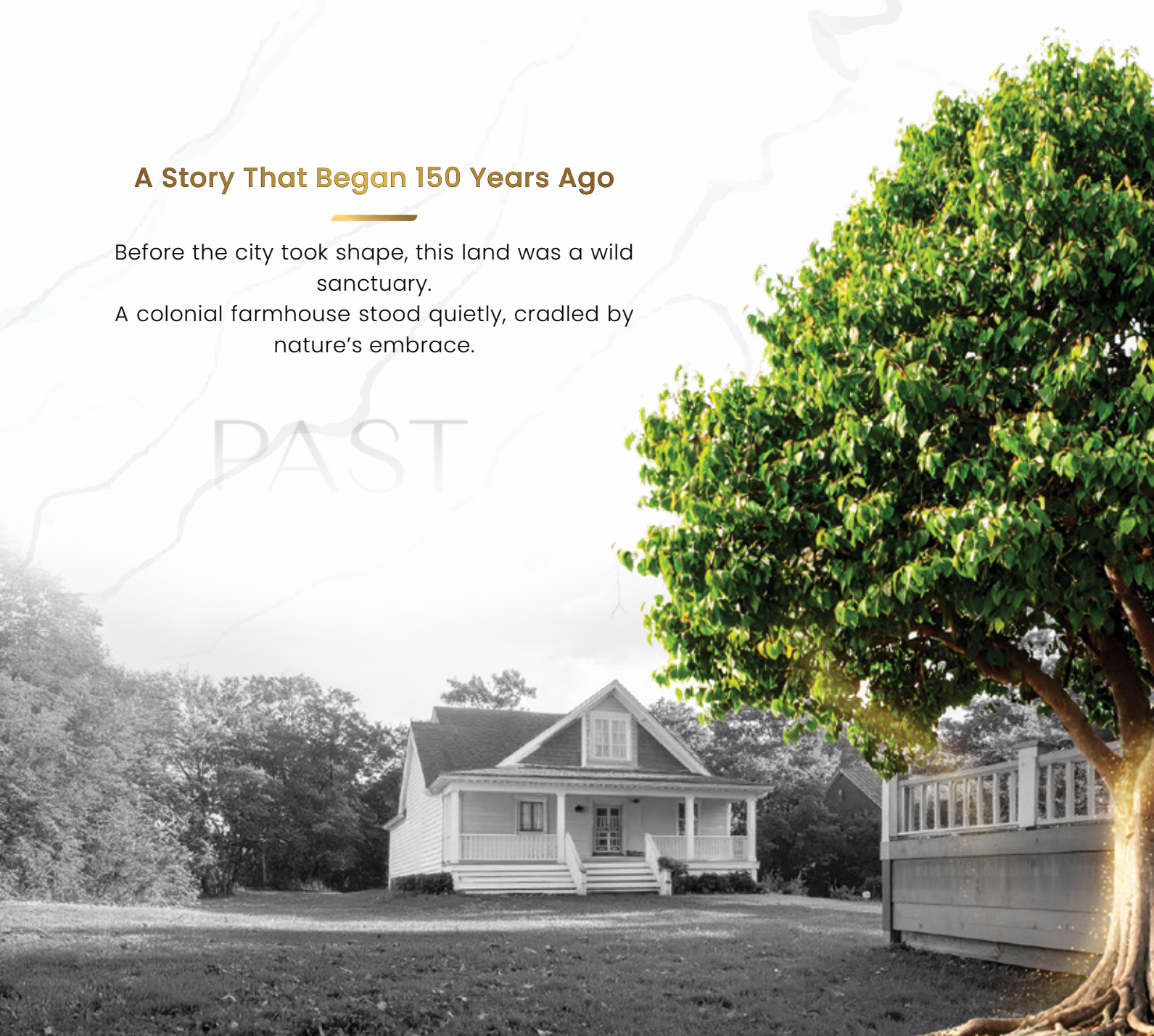

Echoes of the Past, Roots in the Present





**Nature Is Not Just Around Here,
It's Within Here**

From bay windows to open decks, every corner invites
fresh air and green views.
Live surrounded by life, light, and limitless space.

PRESENT

The 80-year-old Bodhi tree and 50+ trees lining the land still whisper history.
We've honored their presence, weaving them into our future.

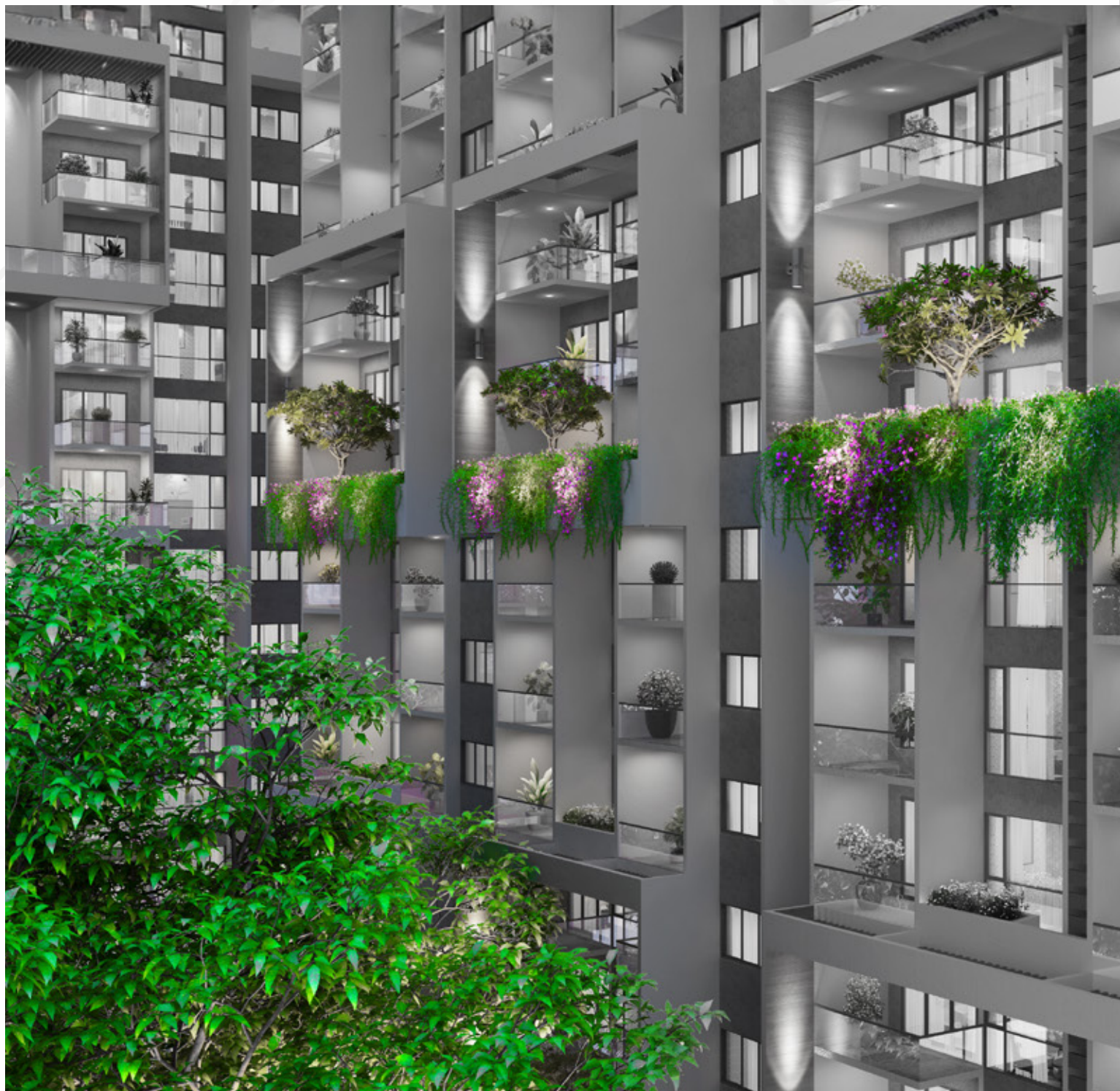



Rendered Image



GREEN THAT
GREET'S YOU LIKE
AN OLD FRIEND

INSPIRED BY DIRECTIONS

Because The Right Place Changes Everything.

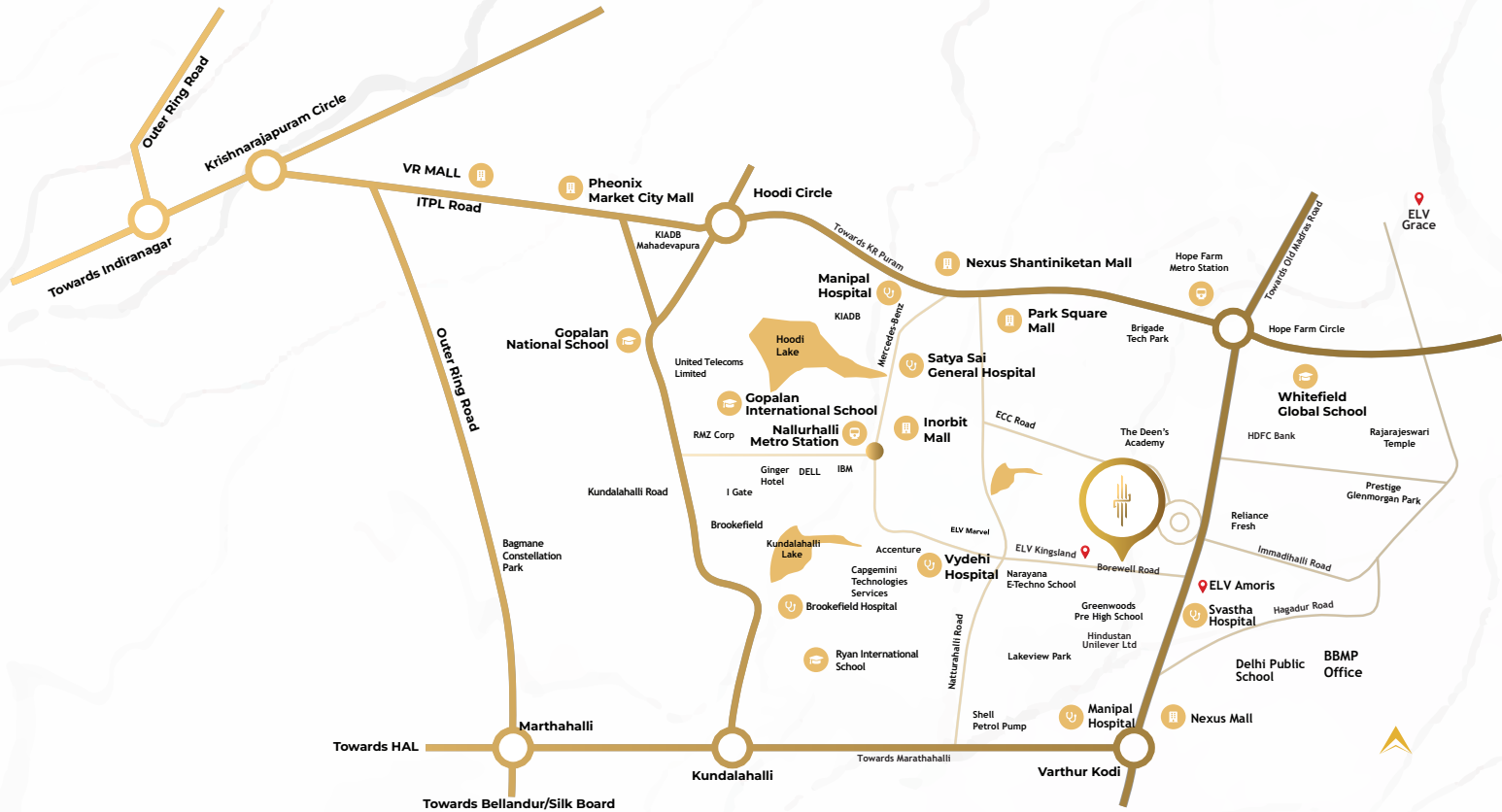

**IN THE
CENTER OF
EVERYTHING**

**5
MINUTES**

**10
MINUTES**

**15
MINUTES**

**20
MINUTES**

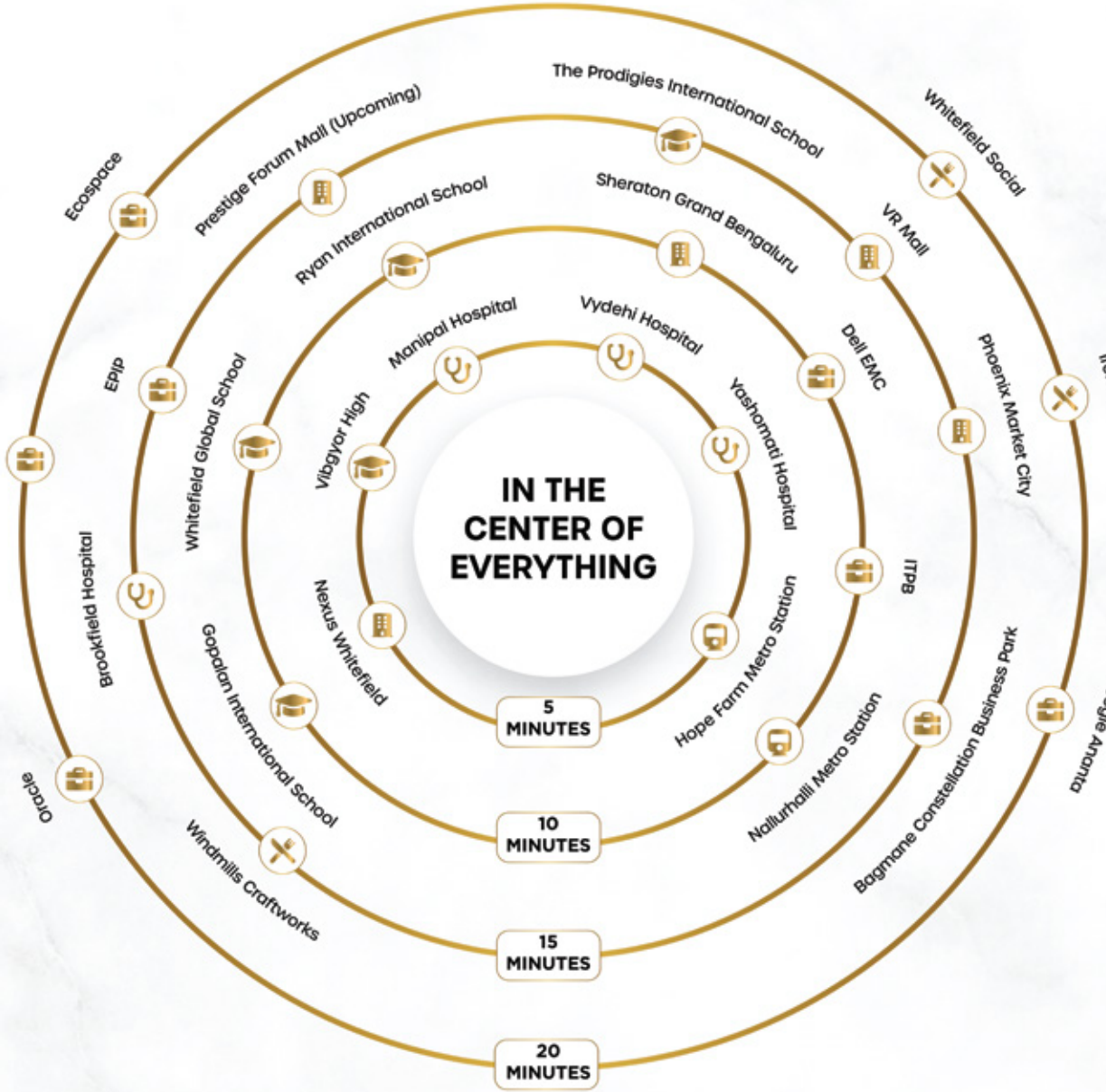

Adobe

Ecospace

Prestige Forum Mall (Upcoming)

Ryan International School

The Prodigies International School

Whitefield Social

Epip

Whitefield Global School

Vibgyor High

Manipal Hospital

Vydehi Hospital

VR Mall

Phoenix Market City

Ironhill

Whitefield Hospital

Gopalan International School

Nexus Whitefield

5 MINUTES

Hope Farm Metro Station

ITPB

Bagmane Constellation Business Park

Google Aranya

Oracle

Windmills Craftworks

10 MINUTES

Nallurhalli Metro Station

ITPB

15 MINUTES

20 MINUTES

MASTER LAYOUT



LEGEND

- | | | | | | |
|----------------------------|---------------------------|--|-------------------|-------------------------|-------------------|
| 01. Security Plaza | 05. Tree House | 09. Outdoor Workstation | 13. Outdoor Cafe | 17. Jogging Track | 21. Squash Court |
| 02. Amphitheater | 06. Half Basketball Court | 10. Vegetable Garden | 14. Water Feature | 18. Cycling Track | 22. Lily Pond |
| 03. Elder's Chit Chat Zone | 07. Cricket Practice Net | 11. Passageway for Underground Parking | 15. Outdoor Gym | 19. Pickup & Drop-off | 23. Infinity Pool |
| 04. Kids Play area | 08. Bicycle Stand | 12. Multipurpose Lawn | 16. Skating Rink | 20. Visitor Car Parking | 24. Water Feature |

AMENITIES



INSPIRED BY BIOPHILIA

Because nature's touch makes
every moment better.



RELAX. REFRESH. REVIVE.



MULTI-PURPOSE
LAWN



UNIQUE
TREE COURT



TREE SCULPTURE



SHALLOW
WATER BODY



VERTICAL
SKY GARDENS
AT EVERY 3RD FLOOR



INTERACTIVE
WATER BODY
WITH JETS



LILY POND





INSPIRED BY COMMUNITY

Because Bonds Make Spaces
Alive.







SWING. SLIDE. SMILE.



LIBRARY



VEGETABLE
GARDEN



ELDERS GYM



REFLEXOLOGY
PATH



FLORAL GARDEN



GYM



YOGA ROOM



SPA & SAUNA



MULTI-PURPOSE
LAWN





INSPIRED BY BALANCE

Because Peace Shapes
Our Days.







PEACE. POWER. PRESENCE.



LIBRARY



VEGETABLE
GARDEN



ELDERS GYM



REFLEXOLOGY
PATH



FLORAL GARDEN



GYM



YOGA ROOM



SPA & SAUNA



MULTI-PURPOSE
LAWN





INSPIRED BY ENERGY

Because Every Day is Full
of Possibilities.

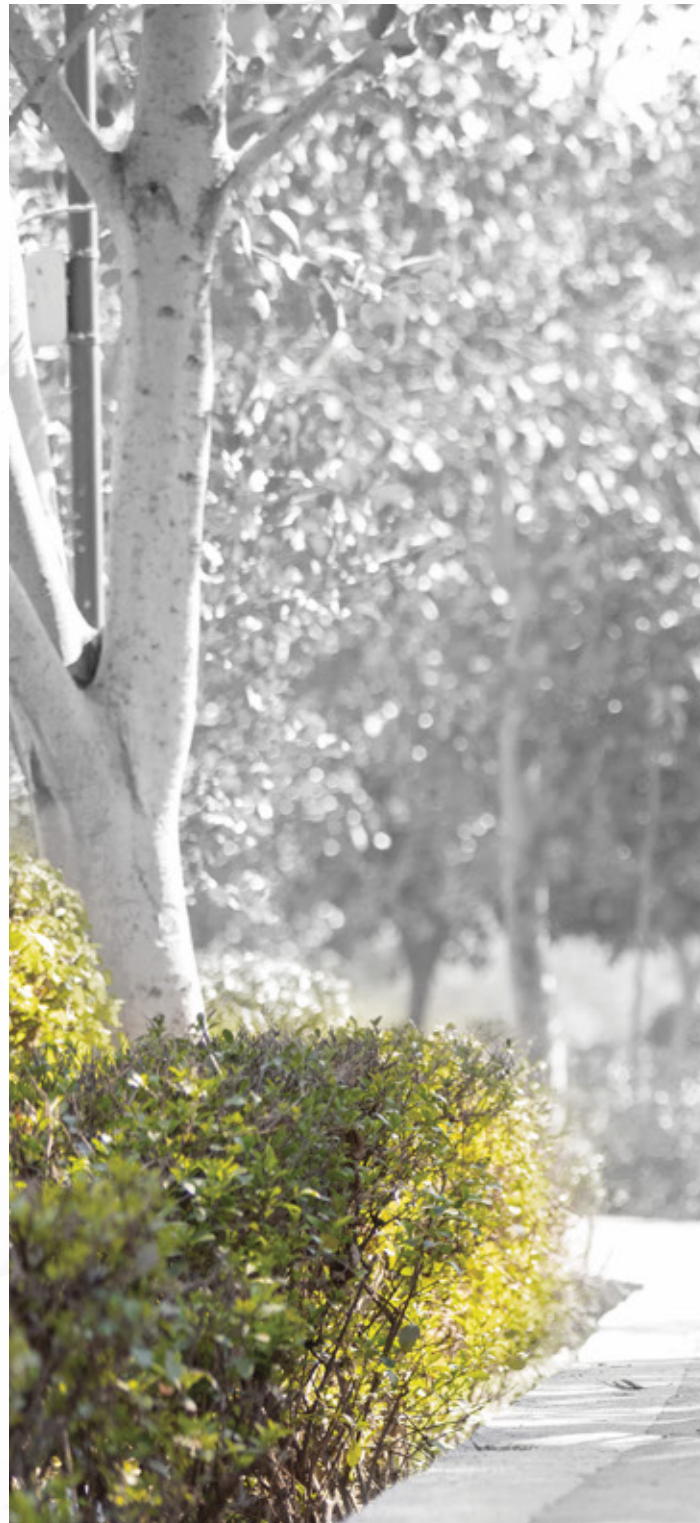





PLAY. RELAX.
REPEAT.



CYCLING TRACK



JOGGING TRACK



SKATING RINK



GIANT CHESS



BADMINTON
COURT



SQUASH COURT



INTERIORS



INSPIRED BY GRACE

Because Life Happens in
Every Detail.

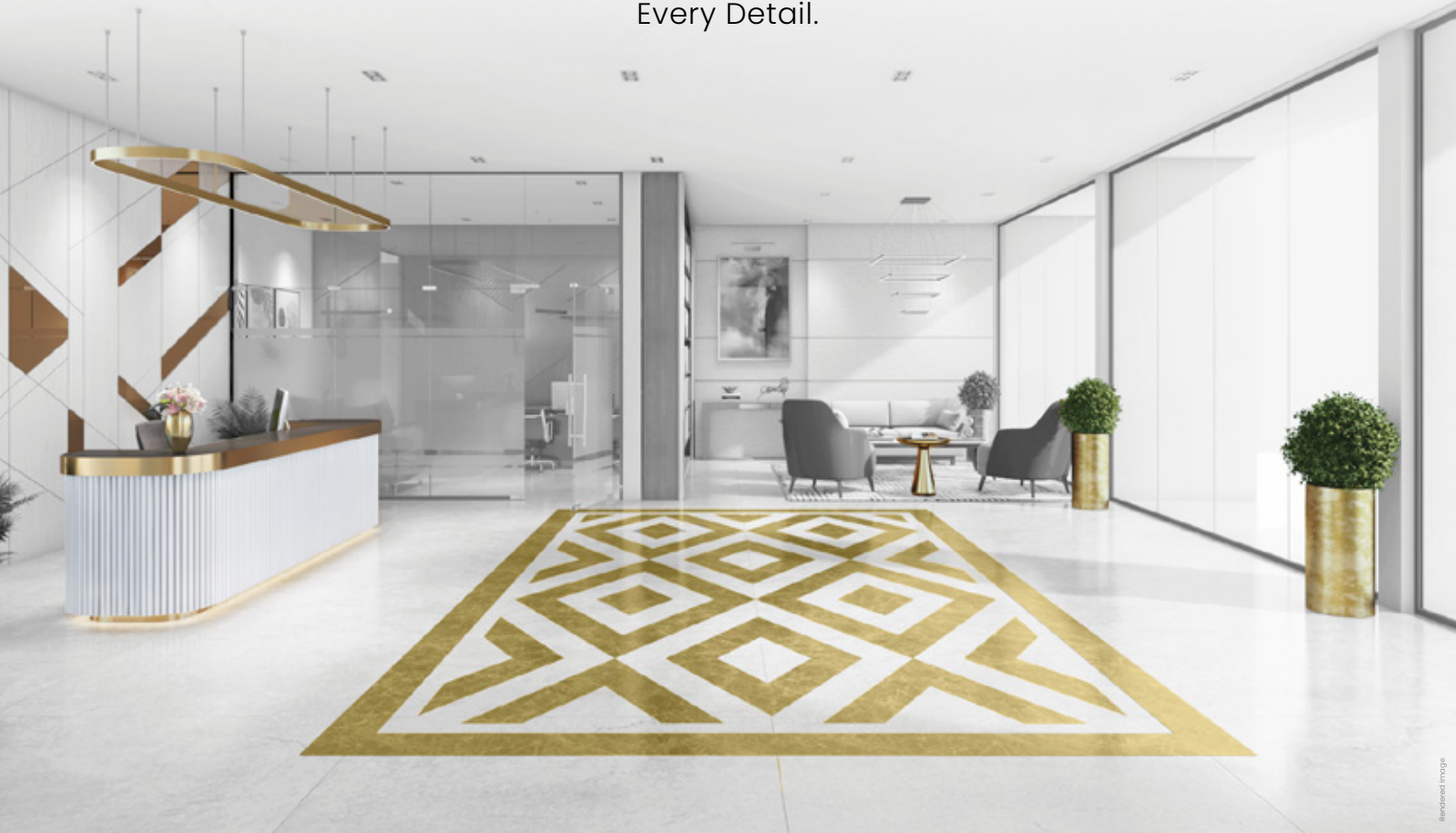



BOUNDLESS SPACES

Just like the comfort you will experience.







INSPIRED BY DETAILS

Perfected for Living.



EV CHARGING PORTS

Designated EV charging ports in the parking area



SANITARY

Jaquar/Equivalent CP fittings & sanitary ware



STRUCTURE

RCC structure walls 6 inches thick external & internal walls.



DOORS

Main Door with teak wood frame with Moulded panel shutter and for internal doors salwood frame with moulded panel shutters.



PAINTING

Asian / Berger / Equivalent emulsion paint for interiors Water proof emulsion paint for exterior



FLOORING

800x800 Vitrified tiles for entire flat, Wooden Flooring for M Bedroom.



ELECTRICAL

Concealed copper wiring with Legrand / Honeywell / Equivalent switches. AC point for M.Bedroom. Provision for aqua guard & Washing machine point.



POWER BACKUP

Generator for common area lightning, lift. Power backup for each floor.



WINDOWS

High Quality UPVC windows.



T.V & TELEPHONE

T.V. & Telephone point in Living & Master bedroom



24*7 SECURITY

Advance 24/7 security with CCTV surveillance



TOILETS

Anti-skid Ceramic tiled flooring and glaze the tile dado.



RERA NO. PRM/KA/RERA/1251/446/PR/181122/005469



THE POWERHOUSE

of Purpose and Precision

COLLAGE ARCHITECT STUDIO

Principal Architect - Since 2021

PRASAD CONSULTANTS

Structural Consultant - Since 2018

SAMPATH KUMAR ASSOCIATES

MEP Consultant - Since 2018

DHRUVA ASSOCIATES

Landscape Consultant - Since 2018

GODREJ & BOYCE

IGBC Consultant - Since 2021

CUSHMAN & WAKEFIELD

Project Management Consultant - Since 2022

I-FORM DESIGN

Mivan Panel Design - Since 2024

BRAND
LEGACY

16+
YEARS



OF Legacy

VALUE

Spaces that appreciate in
worth

300+
ACRES

Of Land Bank



COMMUNITY

Fostering a sense of
belonging



future-ready spaces
with a people-first
approach

COMMITMENT

Backed by
passion and integrity.

5 MILLION
SQ. FT.



Under Development

QUALITY

Raising the bar
higher



1.8k+
HOMES

Under Construction

ELV CARES

Because true foundations
are built with heart

At ELV PROJECTS, every brick we lay carries a story, a story of hope, care, and community.

Our team came together for a **blood donation drive**. It was more than just donating blood, it was about giving a chance, a breath, a tomorrow to someone in need.

Then came the **ELV Champions Trophy**, a lively tournament filled with laughter and fierce competition. But the real victory? Every rupee raised went to supporting cancer warriors and a school for the blind, turning sport into a beacon of hope.

We ran the **Bengaluru East Marathon**, not just to cross the finish line, but to push forward the causes that matter proving that every step can make a difference.

In the quiet corners of our cities, we planted **Miyawaki forests**, tiny green miracles that grow fast and fight pollution, promising a cleaner earth for generations to come.

When the world faced the storm of **COVID**, we stood strong helping those struck hardest with essential supplies and care.

And when **Kerala** was drowned in floodwaters, distance didn't stop us. We reached out, offering aid and comfort to rebuild shattered lives.

We also remember the pillars of our society, our elders. Supporting **old-age homes**, we bring them warmth, respect, and a reminder that they are cherished.

At ELV PROJECTS, these stories are our true foundation. Because building homes is important, but building hope is everything.



CORPORATE ADDRESS:

**ELV Highness Chambers, Borewell Rd, Dodsworth Layout,
Whitefield, Bengaluru, Karnataka - 560066**

RERA NO. PRM/KA/RERA/1251/446/PR/181122/005469

"The Ivory Terraces" is a marketing identity used for promotional purposes only. The official name as registered with RERA is "ELV HIGHGARDEN"