

*life*

Curated by  
Nature



 **SATTVA**  
**FOREST RIDGE**





Presenting

 SATTVA  
**FOREST RIDGE**

## **Homes that embody nature in every sense.**

Sattva Forest Ridge with an ideal location in JP Nagar 9<sup>th</sup> Phase, is the perfect embodiment of Sattva Group's commitment to creating spaces where nature and living spaces co-exist in perfect harmony. With stunning nature views of the Anjanapura Central Park, a stone's throw from the project, you can come home to extraordinary views right in the heart of Bengaluru. Forest Ridge is where nature and life is impeccably entwined in harmony.



## LET NATURE RIGHT INTO YOUR HOME



Created on 4 pristine acres with 407 apartments, Forest Ridge sits on 2 spectacular towers with 3 wings of 30 floors and 28 floors. Designed with care and precision, this residential community integrates the splendor of the outdoors with the luxury of modern living, allowing residents to enjoy both natural beauty and sophisticated comfort. Here, nature becomes a part of everyday life, and every moment feels deeply connected to the heart of nature.

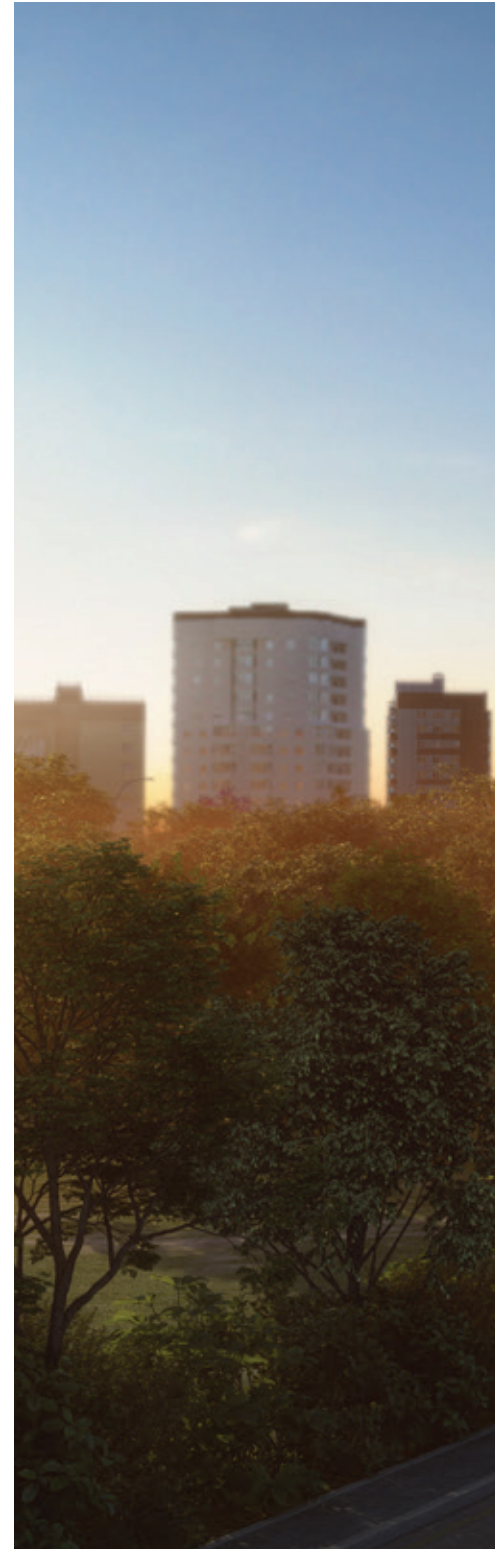





**ANJANAPURA  
CENTRAL PARK  
IS PREPARING**



## ANJANAPURA CENTRAL PARK, ADJACENT TO THE PROJECT

Anjanapura Central Park is a lush oasis where nature and tranquility come together. Nestled near a serene lake, home to a vibrant bird sanctuary with 182 exotic species, it offers a unique experience for nature lovers and bird-watchers alike. This green heartland is an ideal escape away from the din of city life.



# HIGHLIGHTS OF THE PROJECT



4 Acre site with 407 Apartments  
on two towers with 3 wings

---



Homes with wide private terraces  
for green park views

---



30 & 28 floors

---



1, 2 & 3 BHK spacious apartments

---



Stunning Central Park views

---



30,000 Sq ft clubhouse

---



Large swimming pool on the  
podium side

---



100% Vastu compliant homes









## ARCHITECTURAL HARMONY: BLENDING FORM AND FUNCTION



The homes at Sattva Forest Ridge are a celebration of architectural excellence. Every home combines elegant design with modern amenities, creating living spaces that are a class apart. Here, luxury doesn't just reside within four walls—it flows through every detail, every view, and every moment spent in the home.

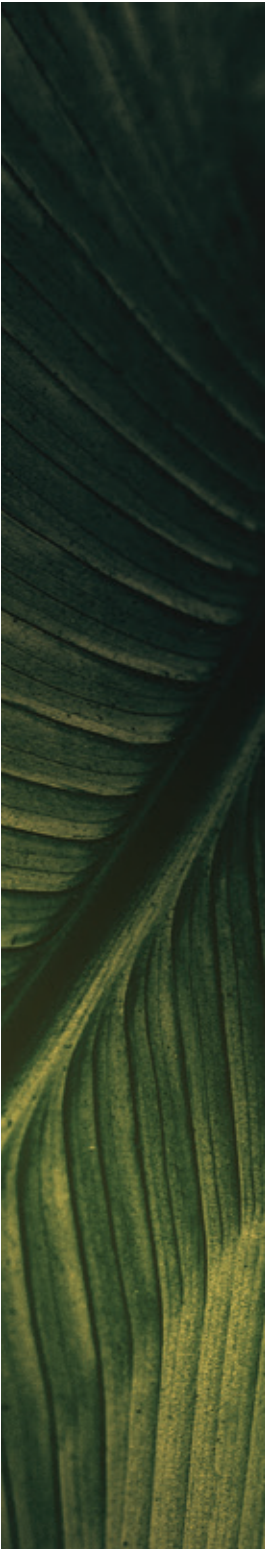

# AMENITIES THAT ENHANCE THE EXPERIENCE



Designed for Wellness, Recreation, and Connection beyond extraordinary homes, Sattva Forest Ridge offers an impressive suite of amenities designed to elevate your daily life. Enjoy a state-of-the-art clubhouse, tranquil walking trails, and endless amenities, all crafted with nature in mind. These spaces offer endless opportunities for relaxation, socializing, and recreation, providing a lifestyle that nurtures both body and mind.









## INDOOR AMENITIES

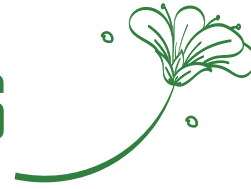

- Party hall
- ATM
- Clinic & pharmacy
- Reception with reading lounge
- Cards room
- Carom & chess room
- Billiards room
- Table tennis room
- Gym
- Department store
- Pool and change room

## OUTDOOR AMENITIES



- Multi-purpose Court
- Pickle ball Court
- Cricket practice pitch
- Kid's play area
- Fitness zone
- Celebration lawn
- Seating alcoves
- Pet Park
- Stepped seating
- Reading nook
- Seniors zone with foot reflexology
- Swimming pool with kid's pool
- Party lawn





# SEAMLESSLY CONNECTED TO ALL YOU NEED URBAN CONVENIENCE MEETS NATURAL RETREAT



Sattva Forest Ridge offers the perfect balance between connectivity and serenity. Located near the NICE Junction, Kanakapura Road, it provides easy access to major IT hubs, while the metro ensures smooth city commutes. Yet, despite its urban convenience, the community is also close to popular weekend getaways, resorts, and nature retreats—offering the best of both worlds: seamless access to city life, with nature always within reach for the perfect escape.

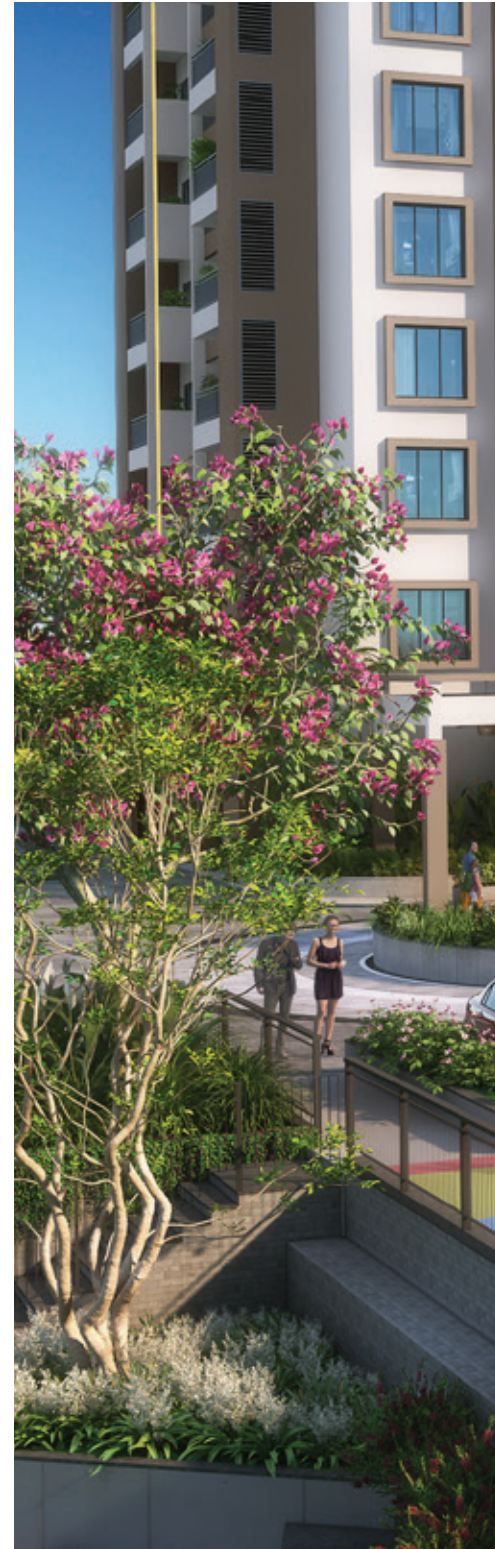



# MASTER PLAN



## LEGEND

1. Security cabin
2. Feature walls
3. Waiting pavilion
4. Celebration lawn
5. Stepped seating
6. Kid's play area
7. Outdoor gym
8. Multi-purpose court
9. Cricket pitch
10. Parking area
11. Party lawn
12. Clubhouse
13. Kid's pool
14. Swimming pool
15. Pool deck
16. Pool cabana
17. Driveway
18. Services
19. Ramp
20. Clock tower
21. Reading nook
22. Seniors zone



# LOCATION MAP



Anjanapura Fire Station	- 3 Min.
JP Nagar 9th Phase	- 3 Min.
NICE Road	- 4 Min.
National Public School	- 6 Min.
Kanakapura Main Road	- 7 Min.
Holiday Village Resort	- 7 Min.
BLR Brewery	- 7 Min.
Konanakunte Metro Station	- 8 Min.
Forum South Mall	- 8 Min.
Cura Hospital	- 9 Min.
Bannerghatta Main Road	- 10 Min.
DMart Kanakapura Road	- 11 Min.
Sri Kumaran Public School	- 12 Min.
Metro Cash & Carry	- 18 Min.
Dayananda Sagar College	- 19 Min.

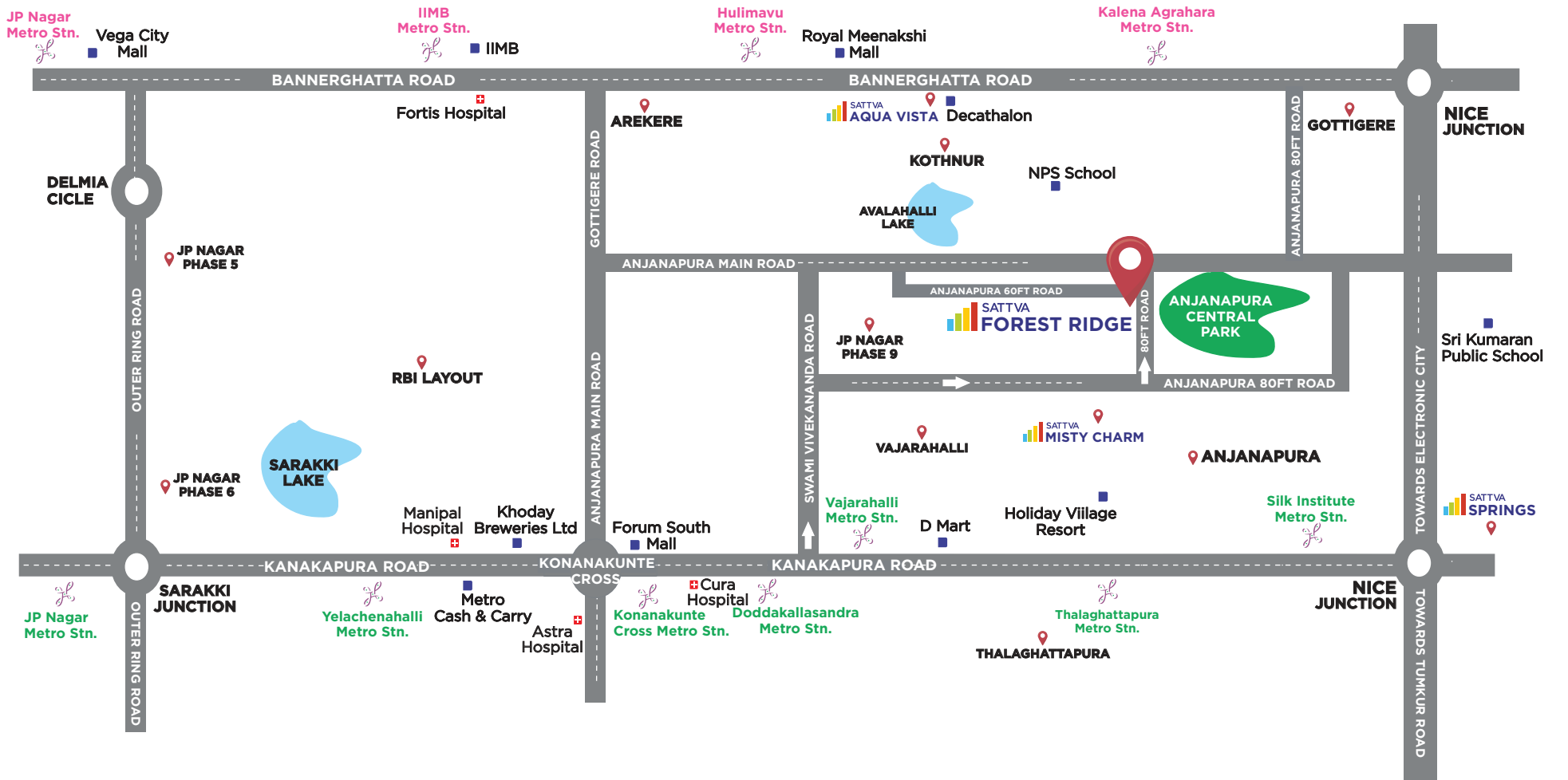



## STRUCTURE

RCC framed structure

## FLOORING & DADO

### a. Common area

Ground floor entrance & Lift lobbies	: Granite/Vitrified flooring
Basement lift lobby	: Vitrified tile flooring
Upper floor lift lobbies	: Vitrified tile flooring
Staircase	: Step/Rest tile flooring
Fire Staircase	: Rest tile flooring
Corridors	: Vitrified tile flooring
Lift jamb will be of granite	

### b. Apartment

Foyer	: Vitrified tiles
Living & Dining	: Vitrified tiles
Master Bedroom	: Vitrified tiles
Other Bedrooms	: Vitrified tiles
Balcony	: Anti-skid ceramic tiles
Kitchen	: Vitrified tiles
Utility	: Anti-skid ceramic tiles

### c. Cladding

Kitchen dado	: Ceramic tiles 600 mm above the counter
Toilet dado	: Ceramic tile dado up to ceiling height

## TOILETS

- Chromium plated fittings for all the toilets
- CP shower for all the toilets
- Health faucet for all the toilets
- Wall mounted EWC with exposed flush valve for all the toilets
- Granite counter with counter-top washbasin in Master Bedroom toilets only and wash basin in all other toilets
- Anti-skid ceramic/vitrified tiles flooring with Matt finish

## KITCHEN

- Electrical Provision for water purifier
- Reticulated Gas piping connection - at extra cost
- Tile dado of 2 feet above Kitchen counter level (Kitchen granite counter & sink will not be provided)
- Hot and cold wall mixer only
- Provision for exhaust fan

# SPECIFICATIONS



## UTILITY

- Inlet & Outlet for washing machine

## DOORS

- Main and Internal doors of RCC frame
- Main door shutter with one side veneer with melamine polish and other side paint finish
- Internal shutters - Flush doors with paint finish

## WINDOWS

- UPVC windows with mosquito mesh (Living/Dining, All Bedrooms & Kitchen)

## PAINTING

- Exterior walls with weather coat texture paint as per design
- Internal walls with internal emulsion
- Enamel paint on all MS railings/ grills

## LIFT

- Automatic passenger lifts

## SECURITY SYSTEMS

- A CCTV camera installed in the Lobby/Security Room /Periphery Vital Points

## ELECTRICAL

- One TV point & telephone point in Living Room & Master Bedroom
- 15 Amp points for Master Bedroom and Living Room for AC, Bedroom with attached toilet provision only
- Individual apartments to have a BESCO power of 1 BHK- 3KVA, 2 BHK & 2.5 BHK - 4KVA, 3BHK - 5KVA

## BACK-UP GENERATOR (AT EXTRA COST)

- 100% back-up on chargeable basis





B(104) - 3BHK+3T  
(Type 1d)  
SBA : 1839 Sq.Ft.  
Carpet : 1202 Sq.Ft.  
Balcony : 96 Sq.Ft.

B(101) - 3BHK+2T  
(Type 2c)  
SBA : 1616 Sq.Ft.  
Carpet : 1022 Sq.Ft.  
Balcony : 111 Sq.Ft.



B(103) - 3BHK+3T  
(Type 1c)  
SBA : 1864 Sq.Ft.  
Carpet : 1207 Sq.Ft.  
Balcony : 110 Sq.Ft.

B(102) - 2.5BHK+2T  
(Type 3b)  
SBA : 1577 Sq.Ft.  
Carpet : 1004 Sq.Ft.  
Balcony : 106 Sq.Ft.

## First Floor Plan - Wing B Tower 1

SBA : SUPER BUILT-UP AREA

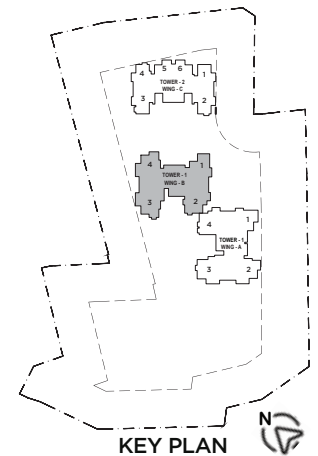

C(104) - 2BHK+2T (Type 4d)  
 SBA : 1200 Sq.Ft.  
 Carpet : 776 Sq.Ft.  
 Balcony : 60 Sq.Ft.

C(105) - 1BHK (Type 5a)  
 SBA : 734 Sq.Ft.  
 Carpet : 465 Sq.Ft.  
 Balcony : 33 Sq.Ft.

C(106) - 1BHK (Type 5b)  
 SBA : 767 Sq.Ft.  
 Carpet : 485 Sq.Ft.  
 Balcony : 33 Sq.Ft.

C(101) - 2BHK+2T (Type 4a)  
 SBA : 1195 Sq.Ft.  
 Carpet : 776 Sq.Ft.  
 Balcony : 60 Sq.Ft.



C(103) - 2BHK+2T (Type 4c)  
 SBA : 1197 Sq.Ft.  
 Carpet : 774 Sq.Ft.  
 Balcony : 60 Sq.Ft.

## First Floor Plan - Wing C Tower 2

SBA : SUPER BUILT-UP AREA

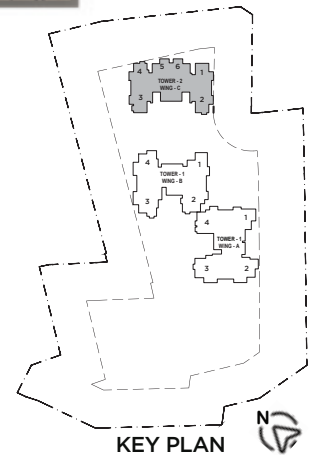

KEY PLAN



# Typical Floor Plan (2nd to 18th & 20th to 28th & 30th Floors)

## - Wing A Tower 1

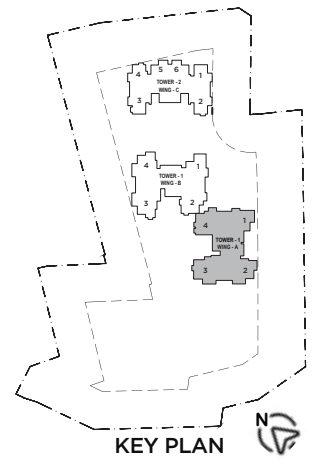

A(204-1804,  
2004-2804, 3004)  
3BHK+2T (Type 2b)  
SBA : 1688 Sq.Ft.  
Carpet : 1091 Sq.Ft.  
Balcony : 104 Sq.Ft.



A(201-1801,  
2001-2801, 3001)  
3BHK+2T (Type 2a)  
SBA : 1609 Sq.Ft.  
Carpet : 1023 Sq.Ft.  
Balcony : 104 Sq.Ft.

A(203-1803,  
2003-2803, 3003)  
3BHK+3T (Type 1b)  
SBA : 1859 Sq.Ft.  
Carpet : 1211 Sq.Ft.  
Balcony : 99 Sq.Ft.

A(202-1802,  
2002-2802, 3002)  
3BHK+3T (Type 1a)  
SBA : 1841 Sq.Ft.  
Carpet : 1201 Sq.Ft.  
Balcony : 97 Sq.Ft.

# Typical Floor Plan (2<sup>nd</sup> to 18<sup>th</sup> & 20<sup>th</sup> to 28<sup>th</sup> & 30<sup>th</sup> Floors) - Wing B Tower 1

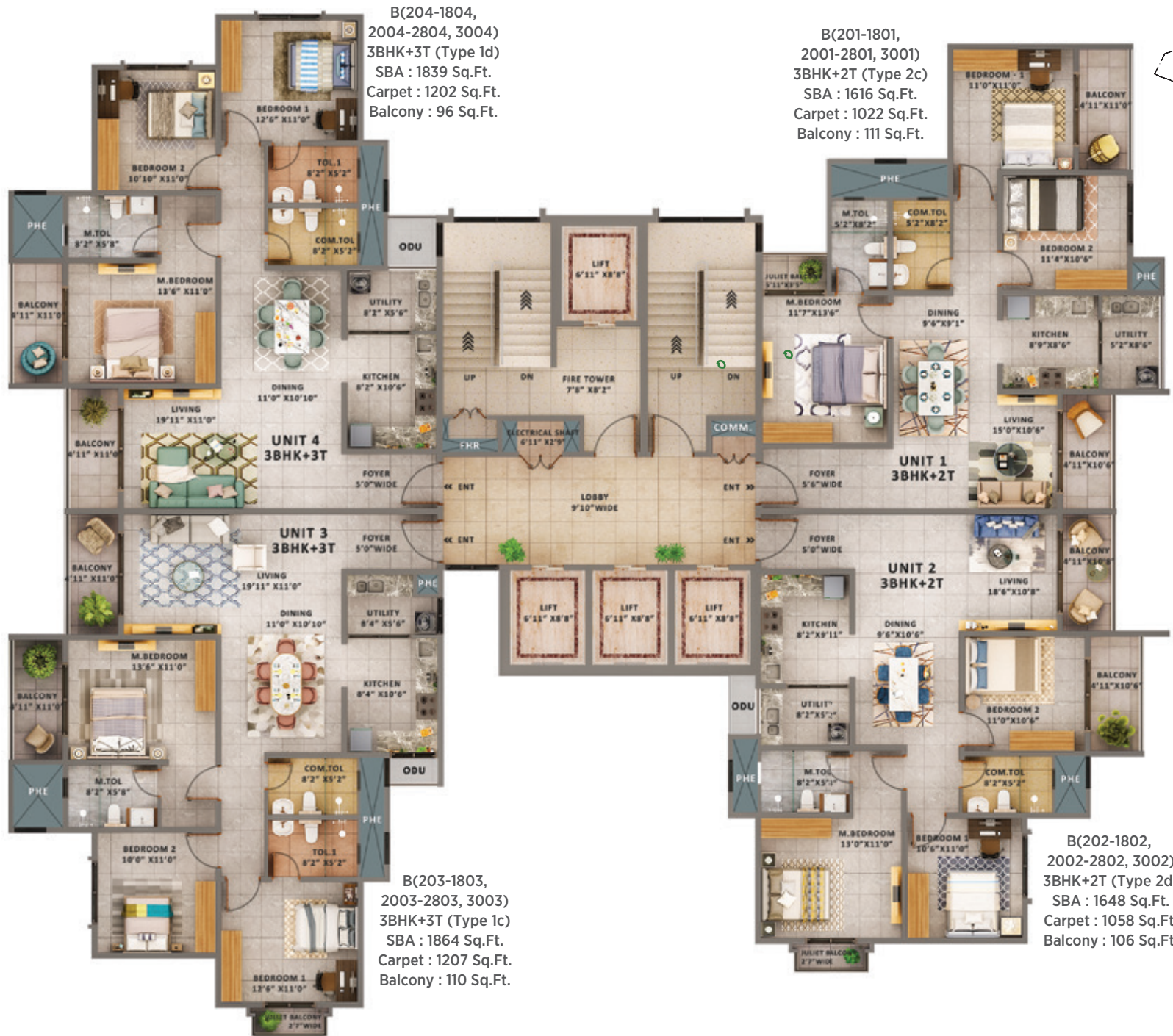
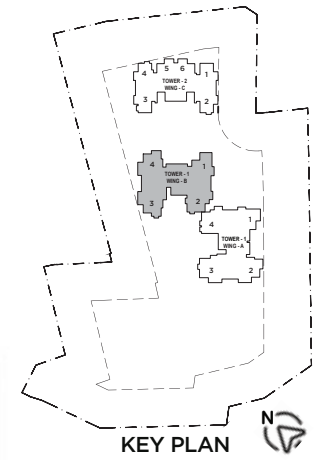

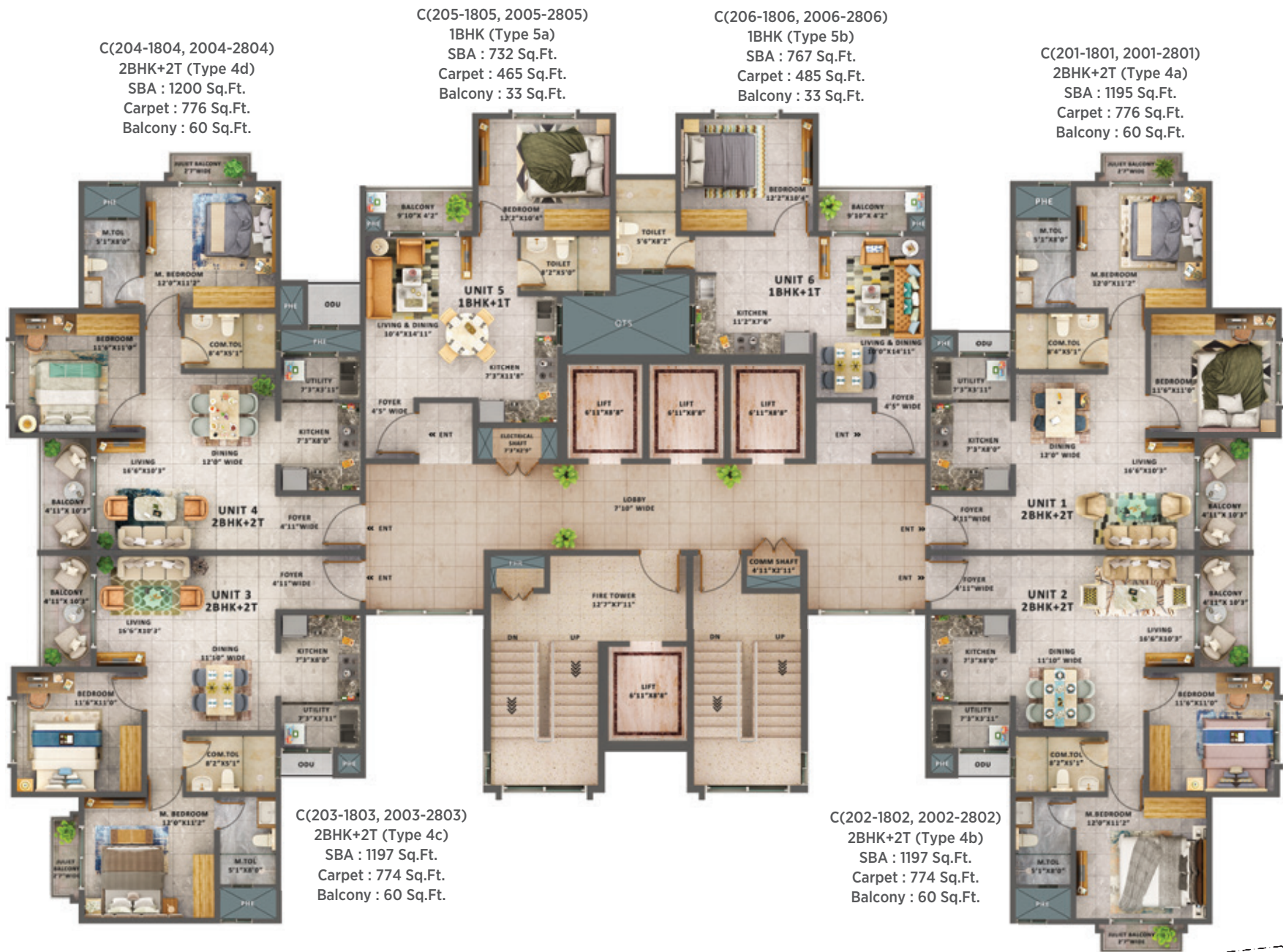

## Typical Floor Plan (2<sup>nd</sup> to 18<sup>th</sup> & 20<sup>th</sup> to 28<sup>th</sup> Floors) - Wing C Tower 2

SBA : SUPER BUILT-UP AREA

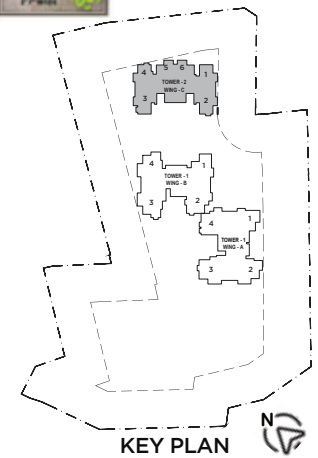

A(1904 & 2904)  
3BHK+2T (Type 2b)  
SBA : 1688 Sq.Ft.  
Carpet : 1091 Sq.Ft.  
Balcony : 104 Sq.Ft.

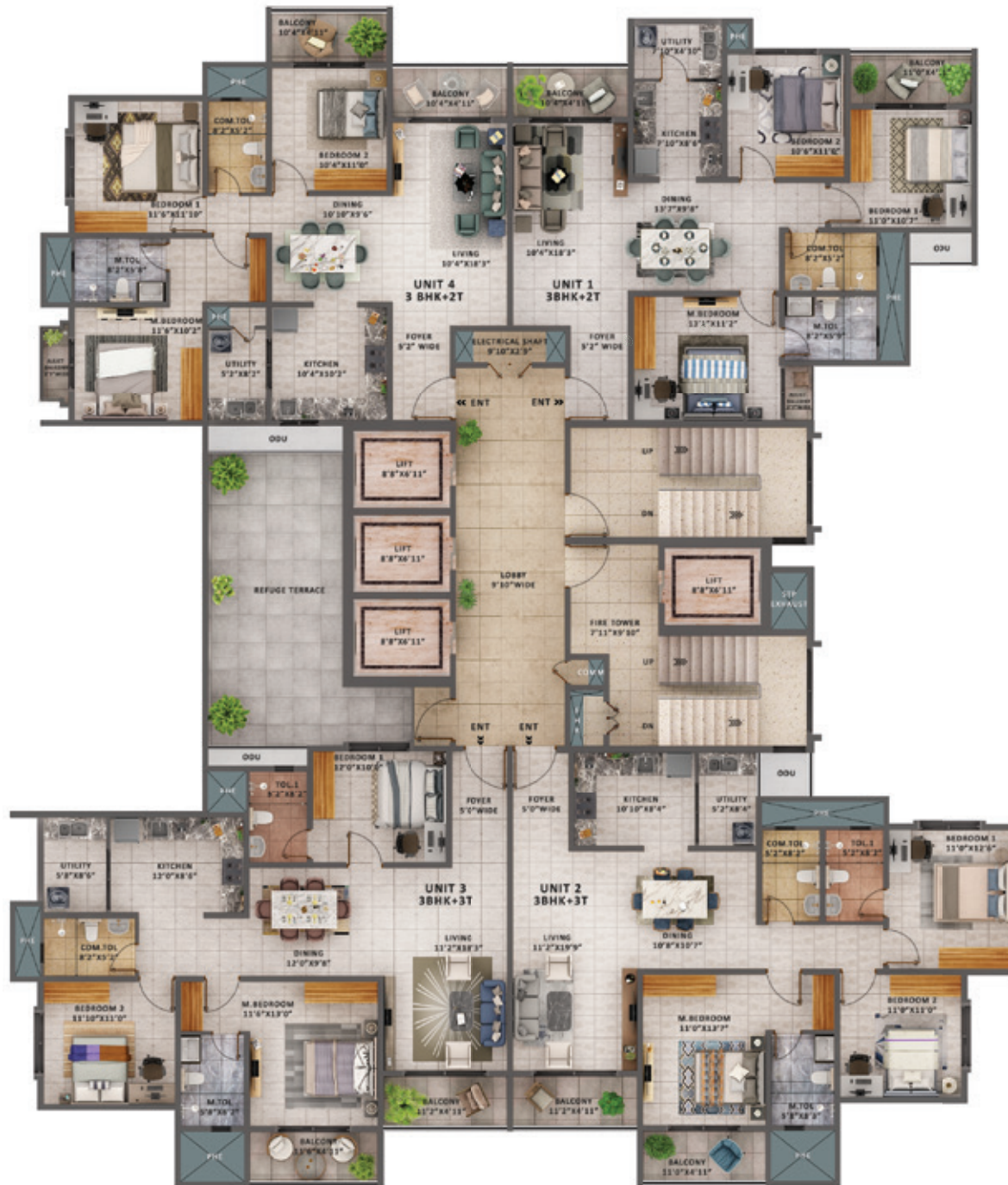

A(1901 & 2901)  
3BHK+2T (Type 2a)  
SBA : 1609 Sq.Ft.  
Carpet : 1023 Sq.Ft.  
Balcony : 104 Sq.Ft.

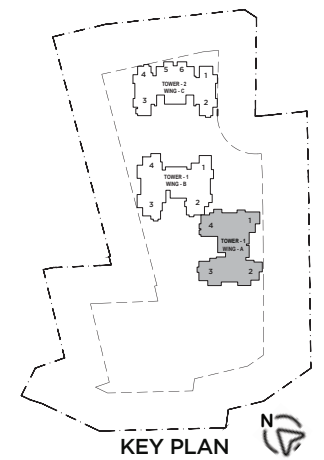

KEY PLAN



A(1903 & 2903)  
3BHK+3T (Type 1b)  
SBA : 1859 Sq.Ft.  
Carpet : 1211 Sq.Ft.  
Balcony : 99 Sq.Ft.

A(1902 & 2902)  
3BHK+3T (Type 1a)  
SBA : 1841 Sq.Ft.  
Carpet : 1201 Sq.Ft.  
Balcony : 97 Sq.Ft.

## 19<sup>th</sup> & 29<sup>th</sup> Floor Plan - Wing A Tower 1

SBA : SUPER BUILT-UP AREA

# 19<sup>th</sup> & 29<sup>th</sup> Floor Plan - Wing B Tower 1

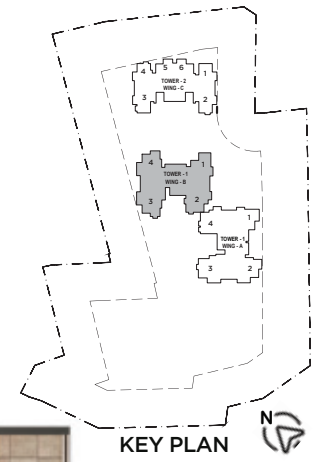

B(1904 & 2904)  
3BHK+3T (Type 1d)  
SBA : 1839 Sq.Ft.  
Carpet : 1202 Sq.Ft.  
Balcony : 96 Sq.Ft.



B(1901 & 2901)  
3BHK+2T (Type 2c)  
SBA : 1616 Sq.Ft.  
Carpet : 1022 Sq.Ft.  
Balcony : 111 Sq.Ft.

B(1903 & 2903)  
3BHK+3T (Type 1c)  
SBA : 1864 Sq.Ft.  
Carpet : 1207 Sq.Ft.  
Balcony : 110 Sq.Ft.

B(1902 & 2902)  
3BHK+2T (Type 2d)  
SBA : 1648 Sq.Ft.  
Carpet : 1057 Sq.Ft.  
Balcony : 106 Sq.Ft.

# 19<sup>th</sup> Floor Plan - Wing C Tower 1

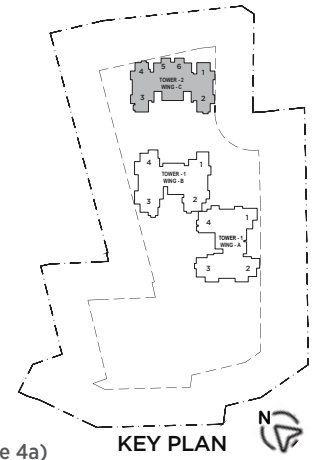

C(1904) - 2BHK+2T (Type 4d)  
 SBA : 1200 Sq.Ft.  
 Carpet : 776 Sq.Ft.  
 Balcony : 60 Sq.Ft.

C(1905) - 1BHK (Type 5a)  
 SBA : 732 Sq.Ft.  
 Carpet : 465 Sq.Ft.  
 Balcony : 33 Sq.Ft.

C(1906) - 1BHK (Type 5b)  
 SBA : 767 Sq.Ft.  
 Carpet : 485 Sq.Ft.  
 Balcony : 33 Sq.Ft.

C(1901) - 2BHK+2T (Type 4a)  
 SBA : 1195 Sq.Ft.  
 Carpet : 776 Sq.Ft.  
 Balcony : 60 Sq.Ft.



C(1903) - 2BHK+2T (Type 4c)  
 SBA : 1197 Sq.Ft.  
 Carpet : 774 Sq.Ft.  
 Balcony : 60 Sq.Ft.

C(1902) - 2BHK+2T (Type 4b)  
 SBA : 1197 Sq.Ft.  
 Carpet : 774 Sq.Ft.  
 Balcony : 60 Sq.Ft.



## 1 BHK + 1 T

Type 5A

Super Built-up Area : 732 Sq.Ft.

Carpet Area : 465 Sq.Ft.

Balcony Area : 33 Sq.Ft.

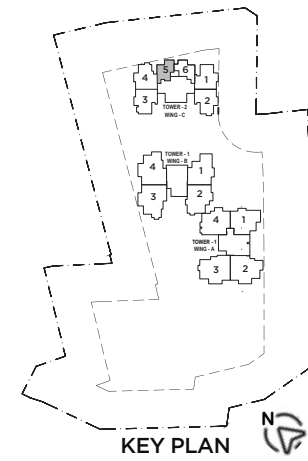

## 1 BHK + 1 T

Type 5b

Super Built-up Area : 767 Sq.Ft.

Carpet Area : 485 Sq.Ft.

Balcony Area : 33 Sq.Ft.

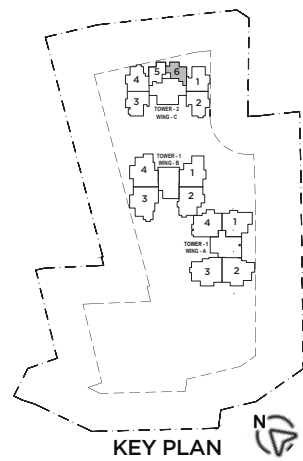

## 2 BHK + 2 T

Type 4A  
Super Built-up Area : 1195 Sq.Ft.  
Carpet Area : 776 Sq.Ft.  
Balcony Area : 60 Sq.Ft.

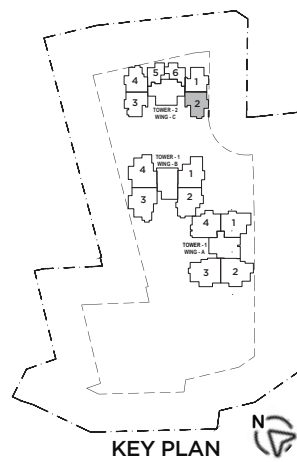
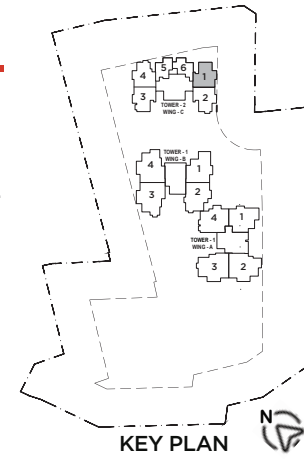

## 2 BHK + 2 T

Type 4b  
Super Built-up Area : 1197 Sq.Ft.  
Carpet Area : 774 Sq.Ft.  
Balcony Area : 60 Sq.Ft.



## 2 BHK + 2 T

Type 4C

Super Built-up Area : 1197 Sq.Ft.

Carpet Area : 774 Sq.Ft.

Balcony Area : 60 Sq.Ft.

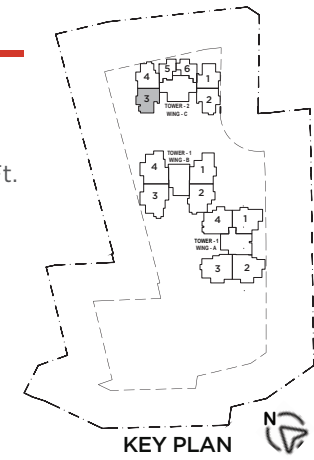

## 2 BHK + 2 T

Type 4D

Super Built-up Area : 1200 Sq.Ft.

Carpet Area : 776 Sq.Ft.

Balcony Area : 60 Sq.Ft.

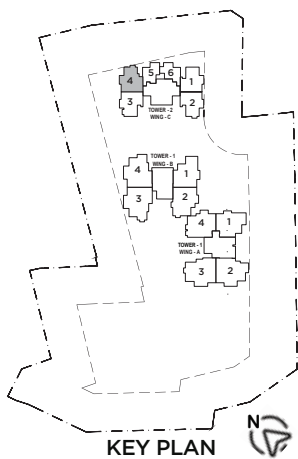



## 2.5 BHK + 2 T

Type 3A

Super Built-up Area : 1588 Sq.Ft.

Carpet Area : 1016 Sq.Ft.

Balcony Area : 104 Sq.Ft.

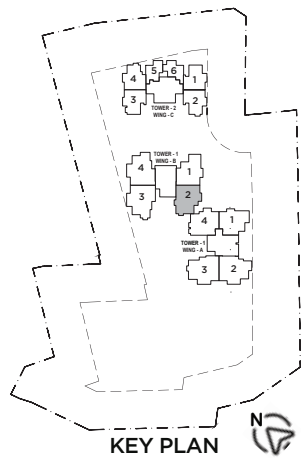
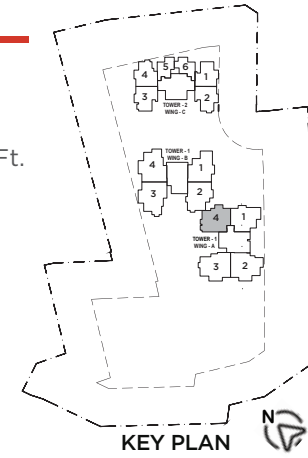

## 2.5 BHK + 2 T

Type 3b

Super Built-up Area : 1577 Sq.Ft.

Carpet Area : 1004 Sq.Ft.

Balcony Area : 106 Sq.Ft.





## 3 BHK + 2 T

Type 2a

Super Built-up Area : 1609 Sq.Ft.

Carpet Area : 1023 Sq.Ft.

Balcony Area : 104 Sq.Ft.

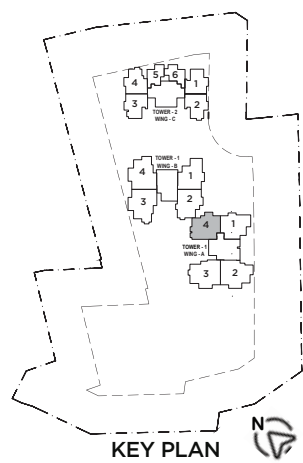
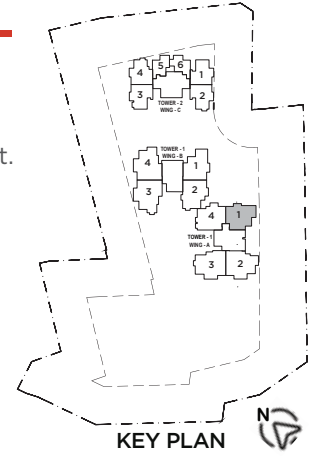

## 3 BHK + 2 T

Type 2b

Super Built-up Area : 1688 Sq.Ft.

Carpet Area : 1091 Sq.Ft.

Balcony Area : 104 Sq.Ft.





## 3 BHK + 2 T

Type 2c

Super Built-up Area : 1616 Sq.Ft.

Carpet Area : 1022 Sq.Ft.

Balcony Area : 111 Sq.Ft.

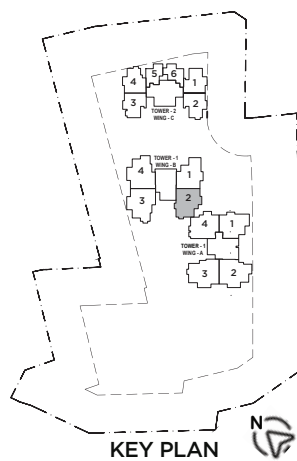
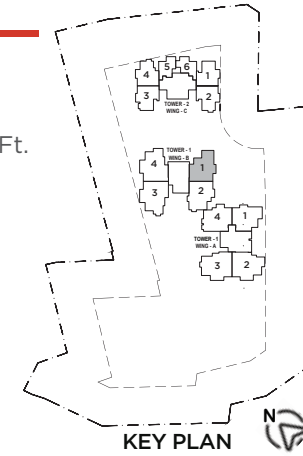

## 3 BHK + 2 T

Type 2d

Super Built-up Area : 1648 Sq.Ft.

Carpet Area : 1057 Sq.Ft.

Balcony Area : 106 Sq.Ft.





## 3 BHK + 3 T

Type 1a

Super Built-up Area : 1841 Sq.Ft.

Carpet Area : 1201 Sq.Ft.

Balcony Area : 97 Sq.Ft.

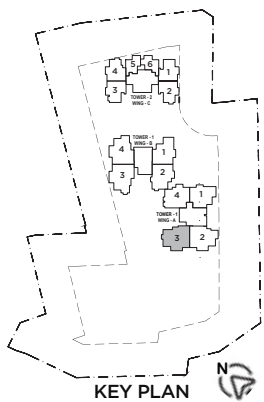
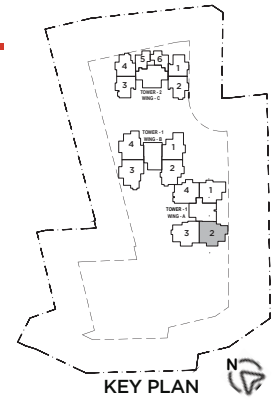

## 3 BHK + 3 T

Type 1b

Super Built-up Area : 1859 Sq.Ft.

Carpet Area : 1211 Sq.Ft.

Balcony Area : 99 Sq.Ft.





## 3 BHK + 3 T

Type 1c

Super Built-up Area : 1864 Sq.Ft.

Carpet Area : 1207 Sq.Ft.

Balcony Area : 110 Sq.Ft.



KEY PLAN

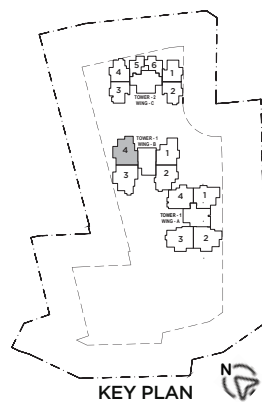

## 3 BHK + 3 T

Type 1d

Super Built-up Area : 1839 Sq.Ft.

Carpet Area : 1202 Sq.Ft.

Balcony Area : 96 Sq.Ft.





# OUR OTHER PROJECTS



LA VITA  
Hennur Road, Bengaluru



SIMPLICITY  
Pattanager Main Rd., Bengaluru



LUMINA  
Yelahanka, Bengaluru



SONGBIRD  
Budigere Main Road, Bengaluru



GREEN GROVES  
Nelamangala, Bengaluru



AEROPOLIS  
NH 44, Bengaluru



PARK CUBIX  
Devanahalli Town, Bengaluru



BLISS  
Off Budigere Road, Bengaluru



KAVERI SIRI  
Acetate Town, Mandya



SPRINGS  
Off Kanakapura Road, Bengaluru



ASHRAYA  
Bengaluru-Mysuru Expressway  
Bidadi



AQUA VISTA  
Bannerghatta Main Road  
Bengaluru



ANUGRAHA  
Vijayanagar Extension  
Bengaluru



MISTY CHARM  
Off Kanakapura Main Road  
Bengaluru



MAGNIFICIA  
Old Madras Road, Bengaluru



LUXURIA  
Malleshwaram, Bengaluru



LAKERIDGE  
Kokapet, Hyderabad



WATER'S EDGE  
Sancoale, Goa



NAVARATNA RESIDENCY  
Avinashi Road, Coimbatore



HM ROYAL  
Kondhwa (Opp. Talab factory)  
Pune

**TRUST.**  
It's what we  
deliver.

Built on the strong foundation of trust, innovation and knowledge-leadership, the Sattva Group is one of India's leading Property Development, Management and Consulting Groups. Founded in 1993, with the primary focus of developing high quality constructions, the Group has attained leadership position and is one of the most preferred brands in the country today. Having pioneered the early development landscape in Bengaluru and literally shaping the city's skyline since the early-90s, the Group has a diverse portfolio of world-class IT parks, Commercial, Residential, Co-working, Co-living, Hospitality and Retail Properties.



74 MILLION SQ. FT.  
COMPLETED

75 MILLION SQ. FT.  
UP-COMING

121 PROJECTS  
COMPLETED

## AWARDS & RECOGNITIONS



**2024**  
ET BEST BRANDS  
CONCLAVE AWARD  
Best Realty Brands 2024  
Sattva Group



**2024**  
ET REAL ESTATE AWARDS  
Commercial Project - Business / IT Parks  
(South : Completed)  
Sattva Knowledge Park



**2024**  
ET REAL ESTATE AWARDS  
Iconic Project - Residential  
(South : Ongoing)  
Sattva LakeRidge



**2024**  
15TH REALTY PLUS  
CONCLAVE & EXCELLENCE AWARDS  
HYDERABAD  
Developer of the Year - Commercial  
Sattva Group



**2024**  
15TH REALTY PLUS  
CONCLAVE & EXCELLENCE  
AWARDS  
HYDERABAD  
Business Leader of the Year  
Bijay Agarwal, MD - Sattva Group



**2024**  
15TH REALTY PLUS  
CONCLAVE & EXCELLENCE AWARDS  
HYDERABAD  
Luxury Project of the Year  
Sattva LakeRidge



**2023**  
REALTY PLUS  
CONCLAVE EXCELLENCE AWARDS  
SOUTH  
Developer of the Year Commercial  
Sattva Group



**2023**  
REALTY PLUS  
CONCLAVE EXCELLENCE AWARDS  
SOUTH  
Iconic Project of the Year  
Sattva Image Tower



**2023**  
COMMERCIAL  
DESIGN AWARDS  
Hall of Fame  
Bijay Agarwal  
MD - Sattva group



**2023**  
SILICON INDIA  
REAL ESTATE AWARDS  
Residential Project of the year  
Sattva Aqua Vista



**2023**  
TIMES BUSINESS AWARDS  
HYDERABAD  
Best Residential Luxury Project  
Sattva LakeRidge



**2023**  
TIMES BUSINESS AWARDS  
BENGALURU  
Residential Project of the Year  
Sattva Park Cubix



**2023**  
ET BUSINESS EXCELLENCE  
2022-2023  
Best Residential Affordable  
Project of the Year  
Sattva Ashraya



**2022**  
REALTY PLUS CONCLAVE  
EXCELLENCE AWARDS, SOUTH  
Developer of the year - Commercial  
Sattva Group



**2022**  
REALTY PLUS CONCLAVE  
EXCELLENCE AWARDS 2022,  
SOUTH  
Commercial Project of the Year  
Sattva Knowledge City



**2022**  
E4M PRIDE OF INDIA BRANDS  
AWARD  
The Best of South  
Sattva Group



**2022**  
THE ECONOMIC TIMES  
REAL ESTATE CONCLAVE  
AWARDS, SOUTH  
Commercial Project - Office Building  
(Completed: Metro)  
Sattva Knowledge City



**2022**  
THE ECONOMIC TIMES  
REAL ESTATE CONCLAVE  
AWARDS, SOUTH  
Commercial Project - Business / IT Parks  
(Completed: Metro)  
Sattva Knowledge Court



**2022**  
TIMES BUSINESS AWARDS  
Bengaluru  
Best Developer Commercial  
Sattva Group



**2021**  
CONSTRUCTION WORLD  
ARCHITECT AND BUILDER  
AWARDS  
Stalwarts of the south, Bengaluru  
Sattva Group



**Corporate Office:** Sattva Group, Sattva Windsor, No.3, Ulsoor Road, Bengaluru - 560042, Karnataka, India.

Tel: +91 80 42699000 Fax: +91 80 42699011

Bengaluru • Hyderabad • Mumbai • Pune • Chennai • Kolkata • Goa • Coimbatore

**Call Toll Free: 1800 121 3344**



A Crisil 'A' STABLE RATED COMPANY  
Founding Member IGBC



An ICRA 'A' STABLE RATED COMPANY  
ISO 9001, 14001 & 18001 CERTIFIED

RERA No: PRM/KA/RERA/1251/310/PR/241224/007315

[www.sattvagroup.com](http://www.sattvagroup.com)

**DISCLAIMER :** The brochure is purely conceptual in nature and is by no means a legal offering. The promoters reserve the right to change, delete or add any specifications or plans mentioned herein. Furniture layout is indicative only.